



**SPS BIOCLIMATIC**

# TECHNICAL CATALOG

2026

LINK WITH US:



[spsbioclimatic.com](https://spsbioclimatic.com)



[sps\\_bioclimatic](https://www.instagram.com/sps_bioclimatic)



[spsbioclimatic](https://www.pinterest.com/spsbioclimatic)

- 1 BIOCLIMATIC PERGOLA**
- 2 PERGOLA SYSTEM**
- 3 GUILLOTINE GLASS SYSTEMS**
- 4 SLIDING SYSTEM**
- 5 ZIP SCREEN**
- 6 WIND BREAKER**



**SPS BIOCLIMATIC**

**BIOCLIMATIC PERGOLA**

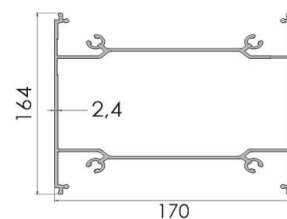
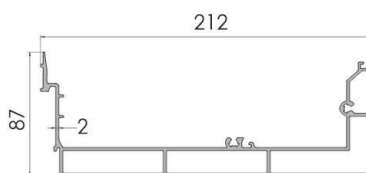
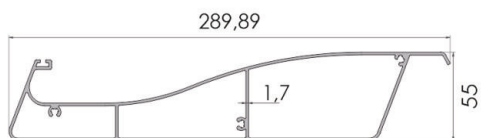
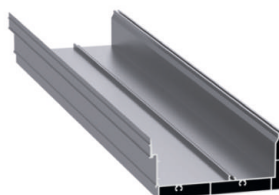
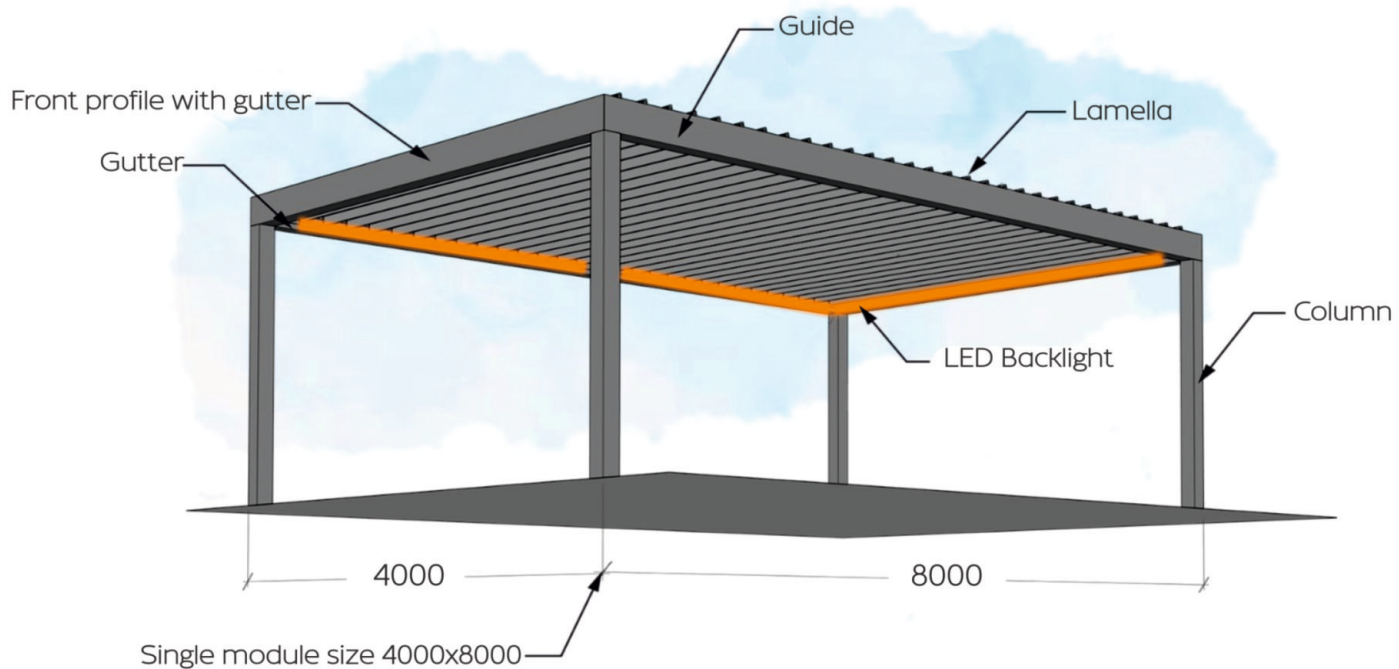

**INFORMATION:**

Maximum width mm	4000
Maximum length mm	8000
Weight kg/m <sup>2</sup>	30
Snow load kg/m <sup>2</sup>	150

**Average service life: from 10 years**

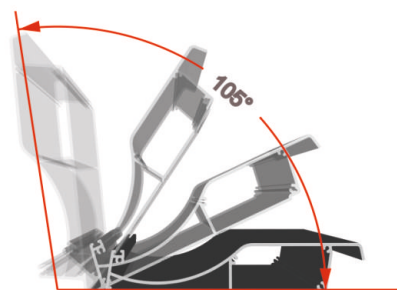

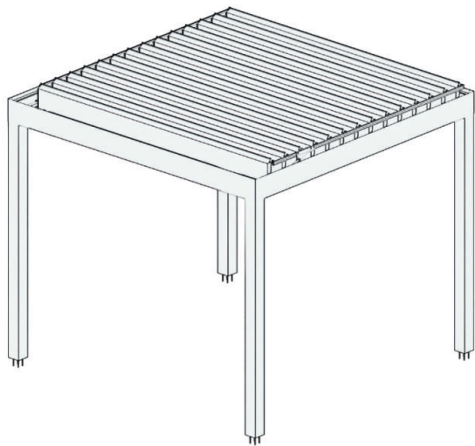

**SINGLE SYSTEM**



**BIOCLIMATIC DOUBLE SYSTEM**



**BIOCLIMATIC MULTIPLE SYSTEM**

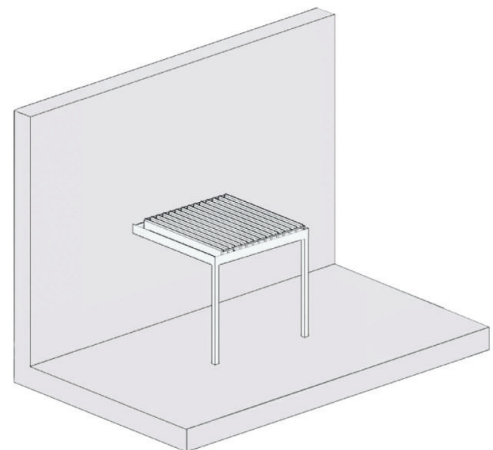

**BIOCLIMATIC SINGLE SYSTEM**

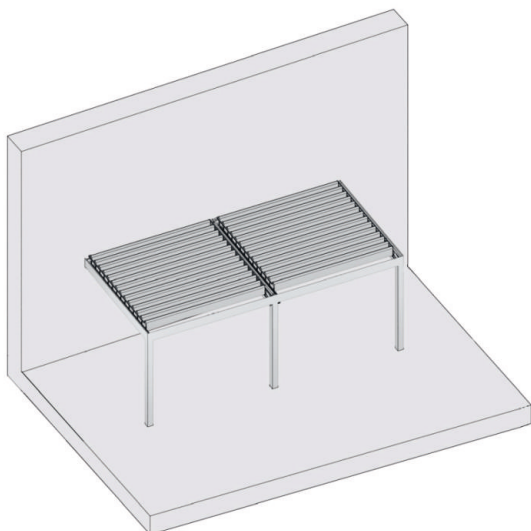

**BIOCLIMATIC DOUBLE SYSTEM**

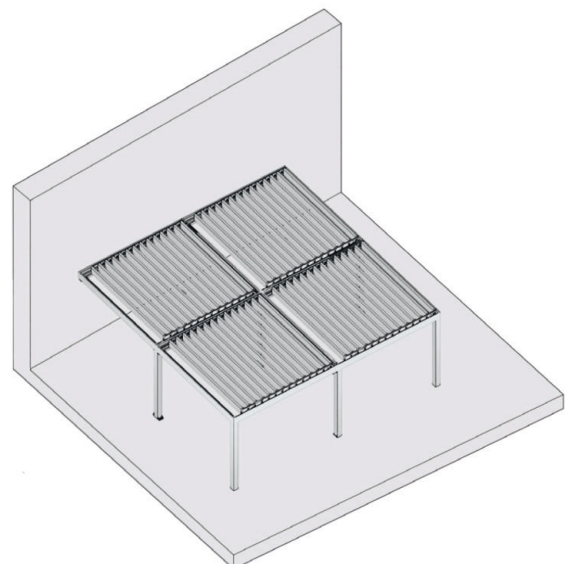

**BIOCLIMATIC MULTIPLE SYSTEM**

1

Cut threads using M6 and M8 tap drill bits.

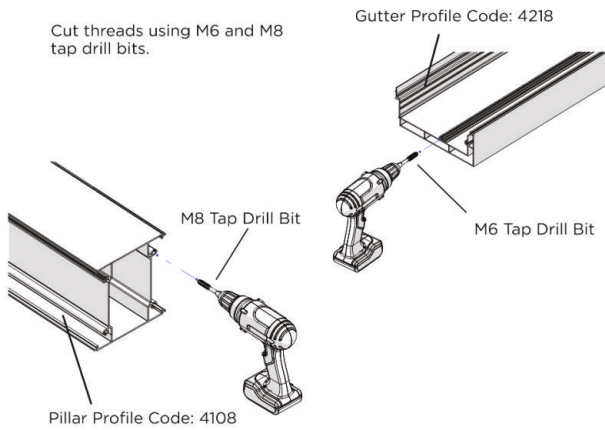

2

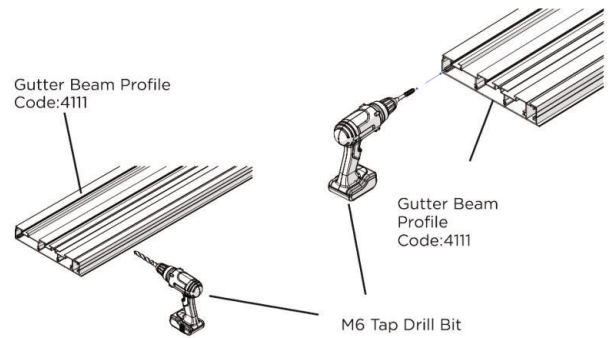

Create the openings where the groove upright profiles will interlock with the base upright. (Detail 1)

3

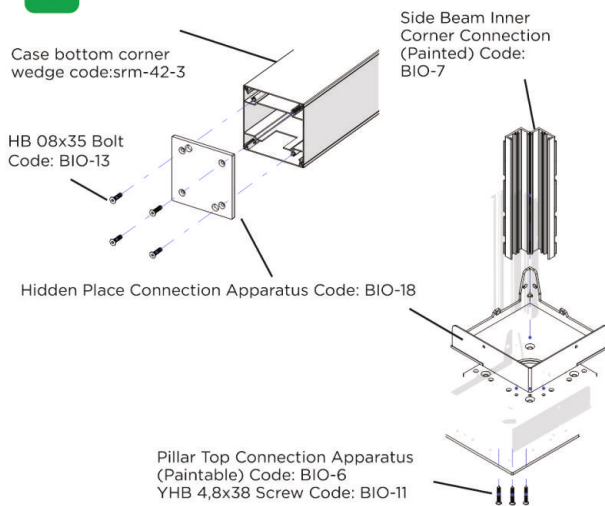

4

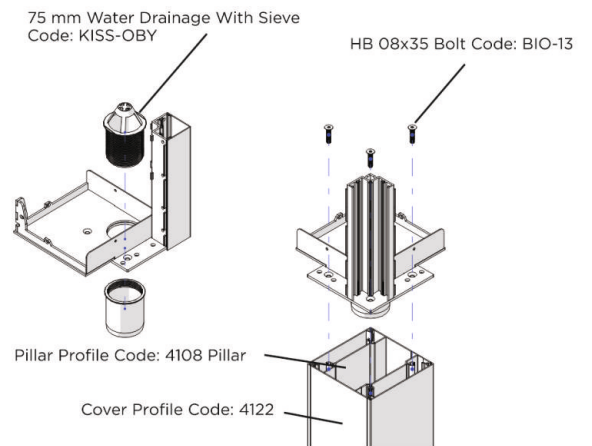

5

After assembling the base profile and the upper connection bracket together, install the M8 25x25 Flat bars Code: bio 10 through which the groove upright profiles will pass.

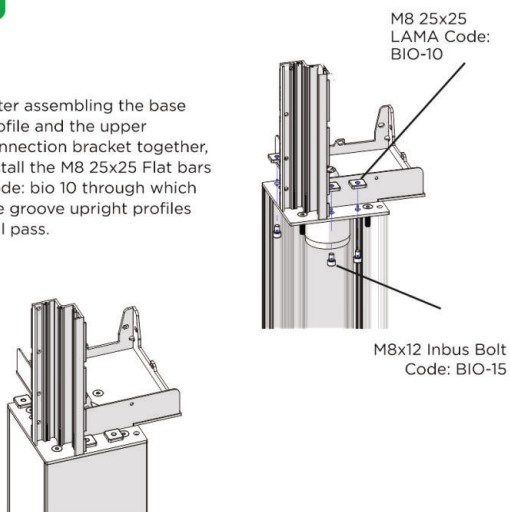

6

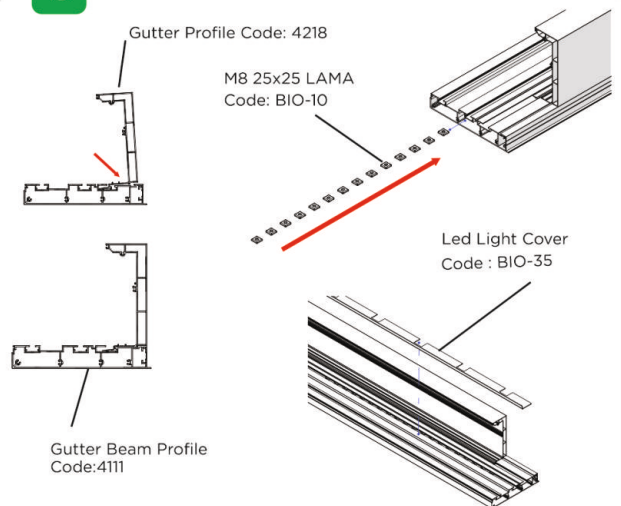

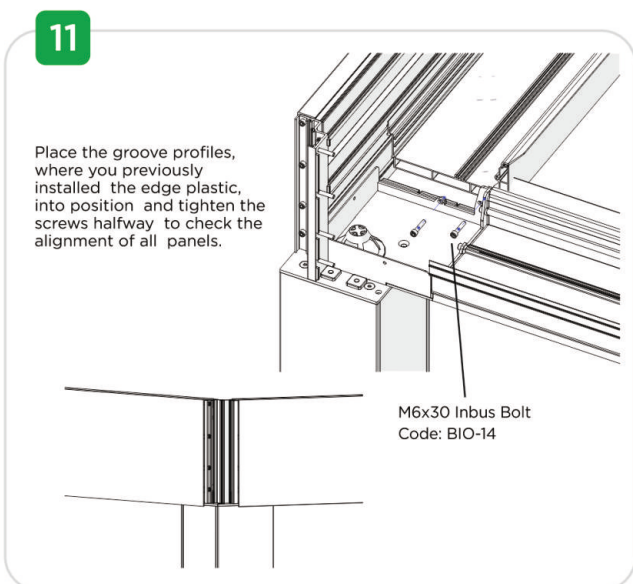
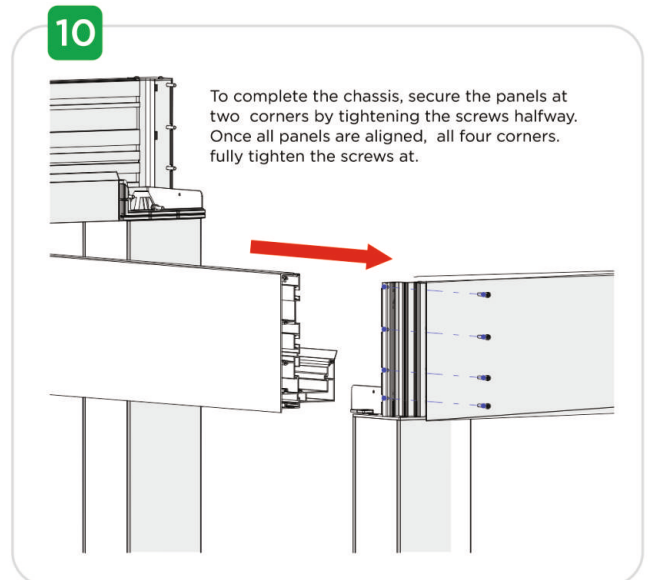
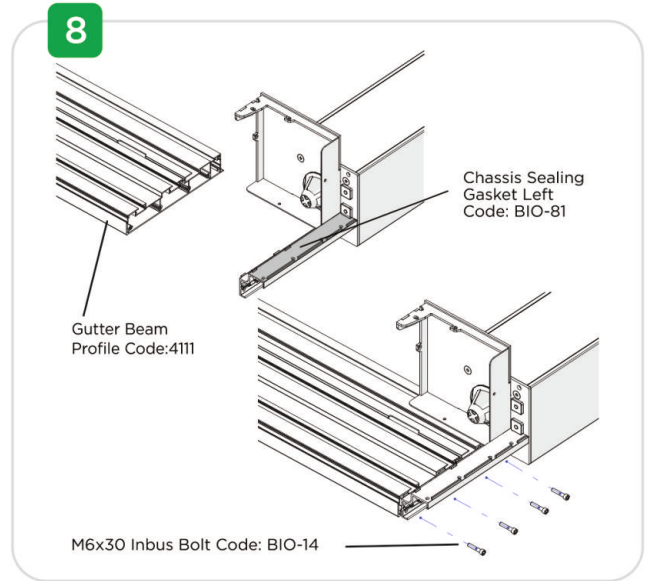
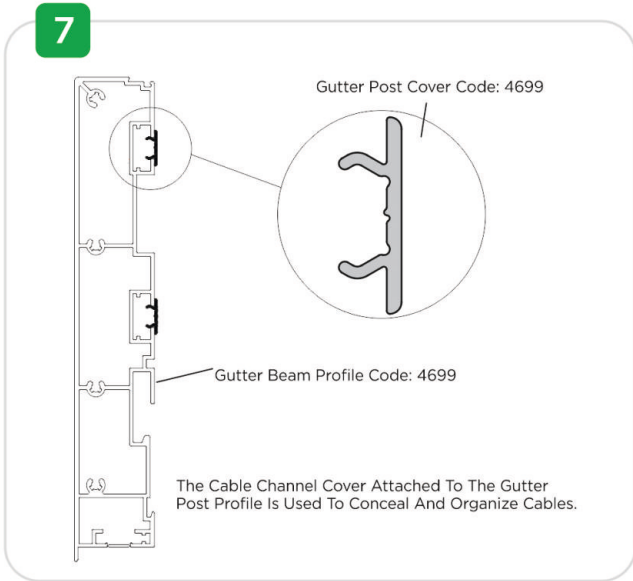

1

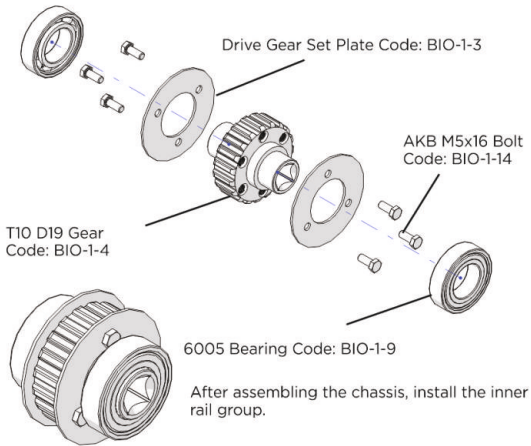

2

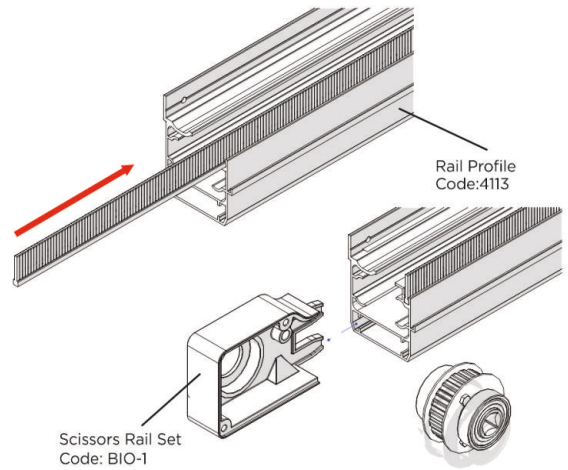

3

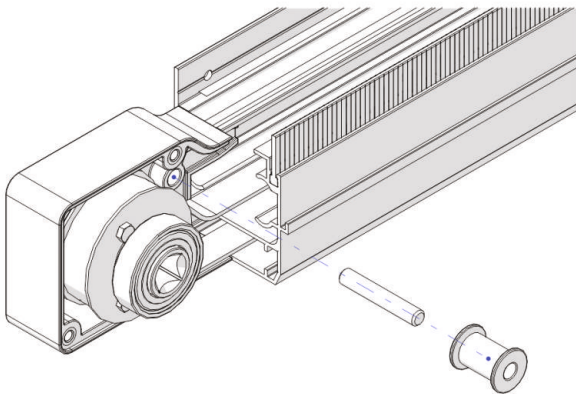

4

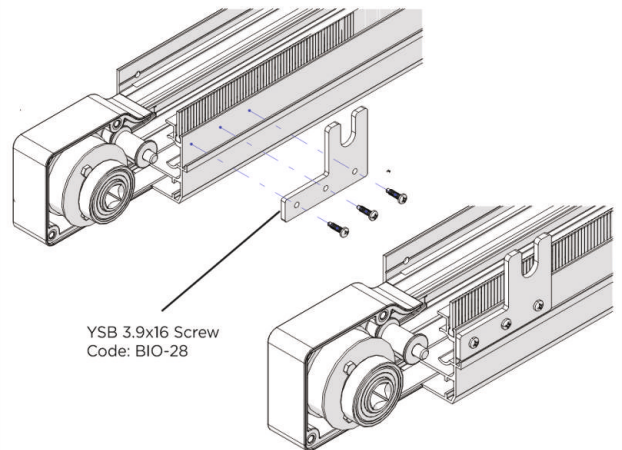

5

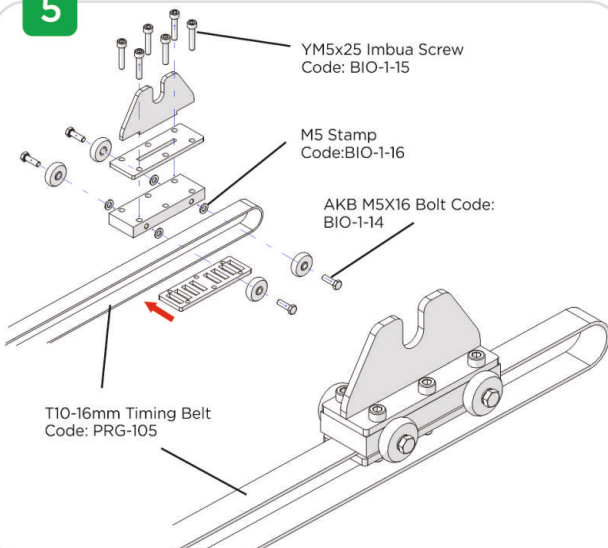

6

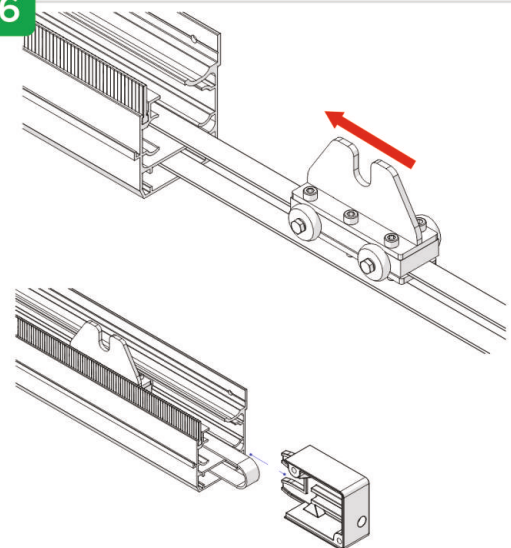

7

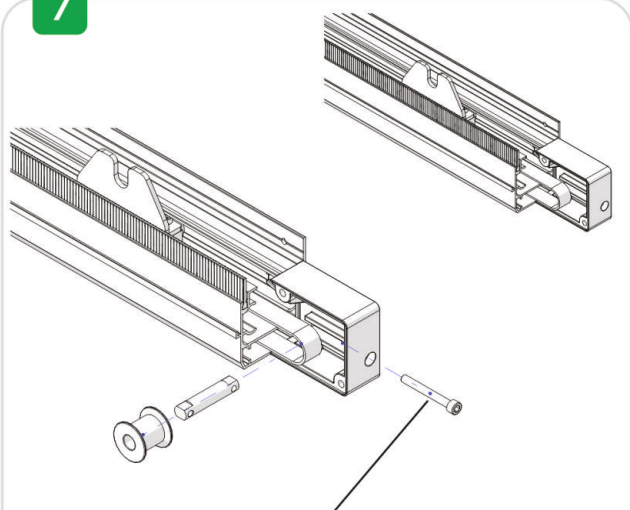

M6x50 Allen Bolt Code: BIO-1-24

8

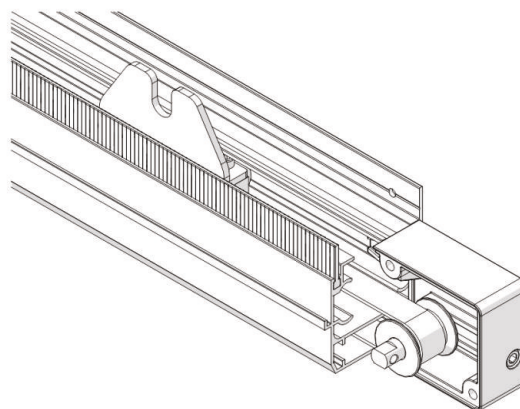

Note: Pay attention to the directions of the profiles and plastics.

9

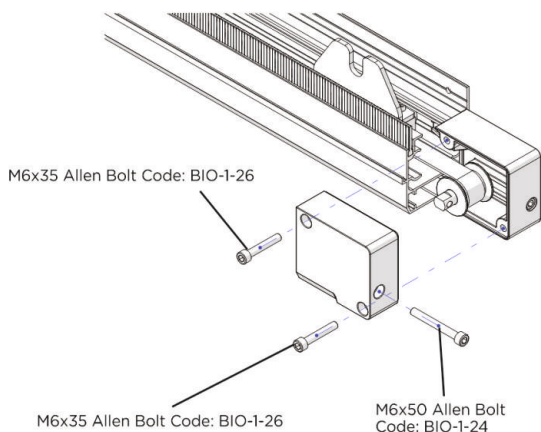

M6x35 Allen Bolt Code: BIO-1-26

M6x35 Allen Bolt Code: BIO-1-26

M6x50 Allen Bolt Code: BIO-1-24

10

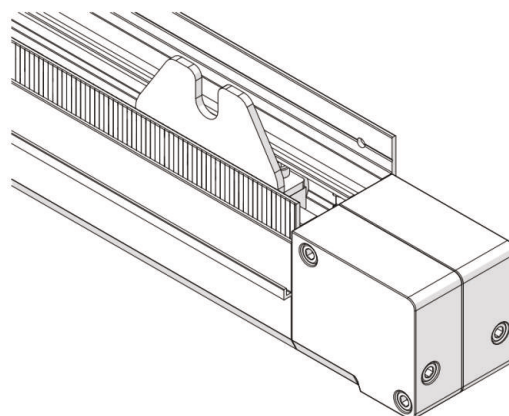

11

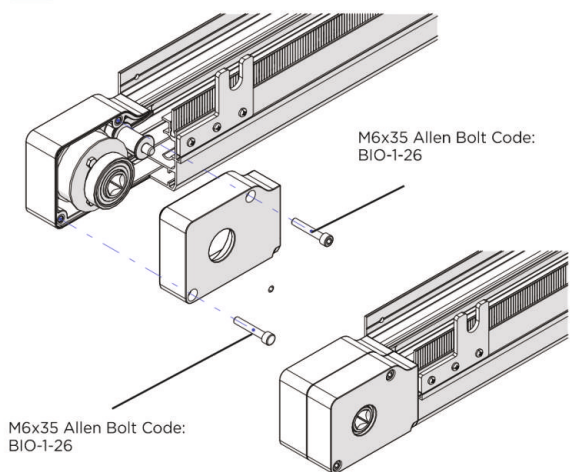

M6x35 Allen Bolt Code: BIO-1-26

M6x35 Allen Bolt Code: BIO-1-26

12

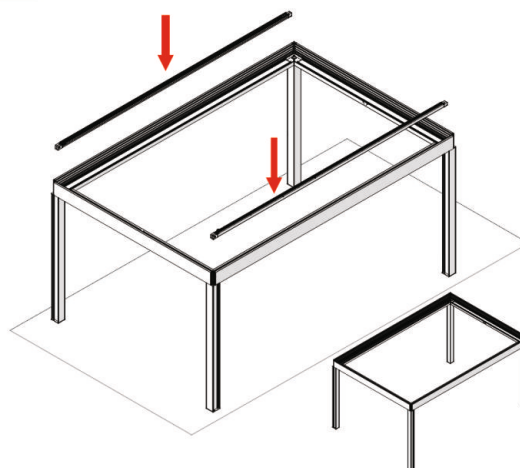

1

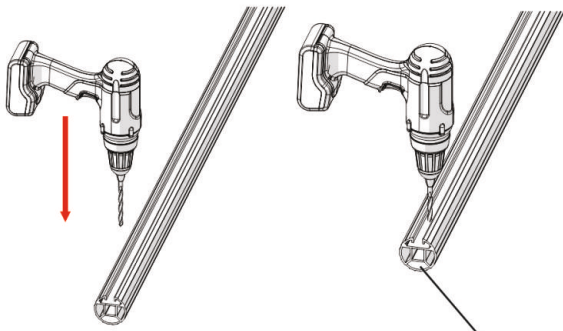

Shaft Profile Code: 4115

Drill holes into the shaft profile to determine the position for the M8 25x25 flat bar.

2

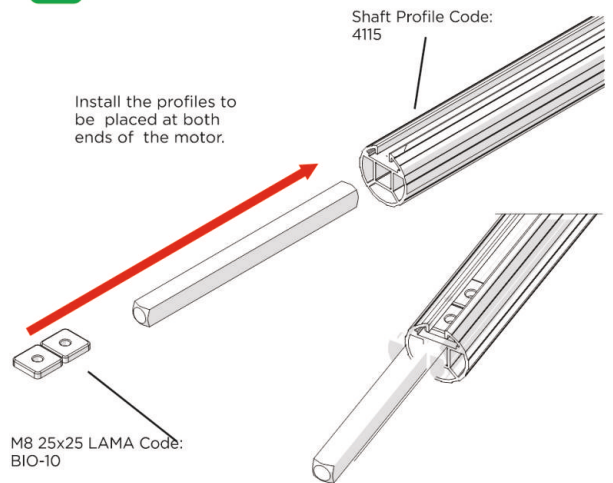

Install the profiles to be placed at both ends of the motor.

M8 25x25 LAMA Code: BIO-10

3

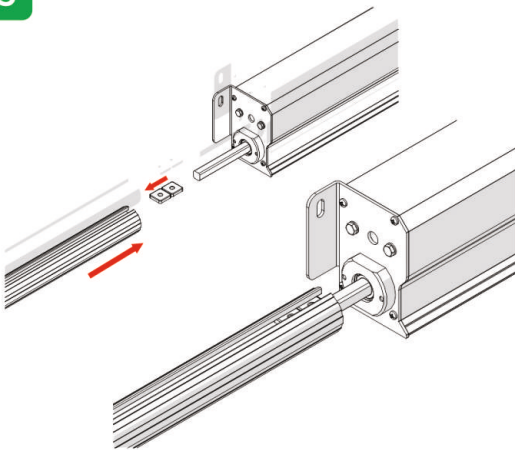

Check the holes at both ends of the shaft profile and position both sides as shown in the drawing.

4

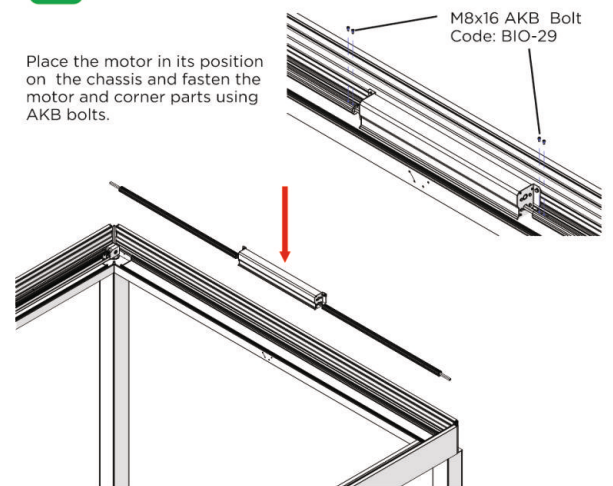

Place the motor in its position on the chassis and fasten the motor and corner parts using AKB bolts.

M8x16 AKB Bolt Code: BIO-29

5

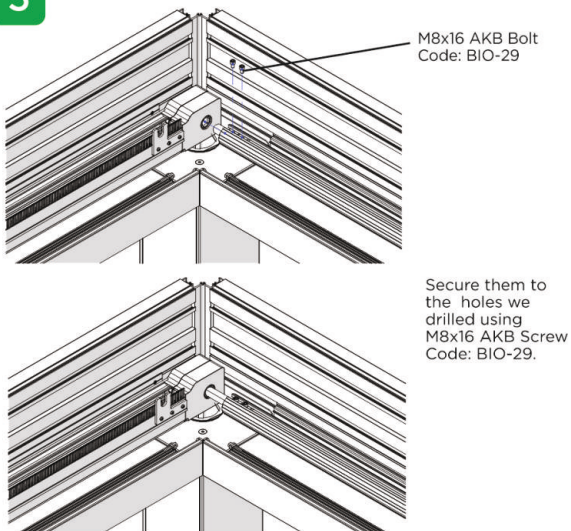

M8x16 AKB Bolt Code: BIO-29

Secure them to the holes we drilled using M8x16 AKB Screw Code: BIO-29.

6

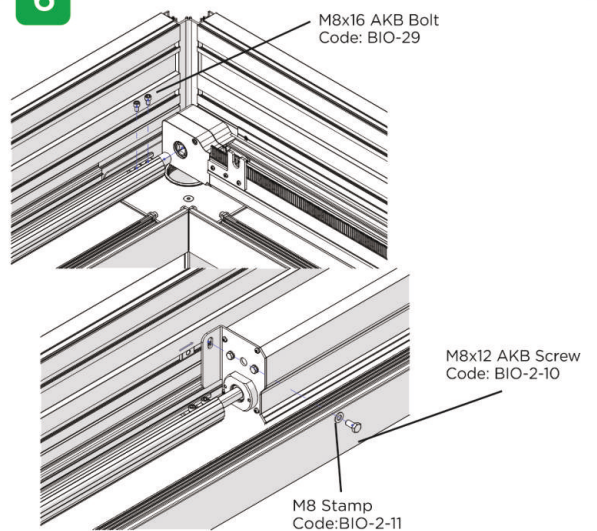

M8x16 AKB Bolt Code: BIO-29

M8x12 AKB Screw Code: BIO-2-10

M8 Stamp Code: BIO-2-11

1

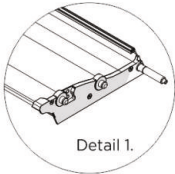
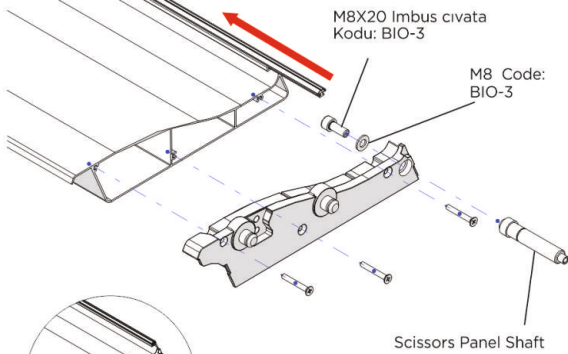

First, install the motor side fixed panel. Pay attention to the details in Detail 1.

Motor Side Fixed Panel

2

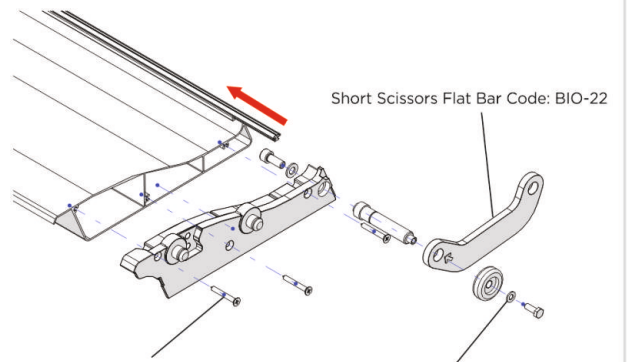

AKB M8x16 Bolt  
Code: BIO-29

M6 Washer Code: BIO-53

Motor Side 2nd Panel (Short Scissors)

3

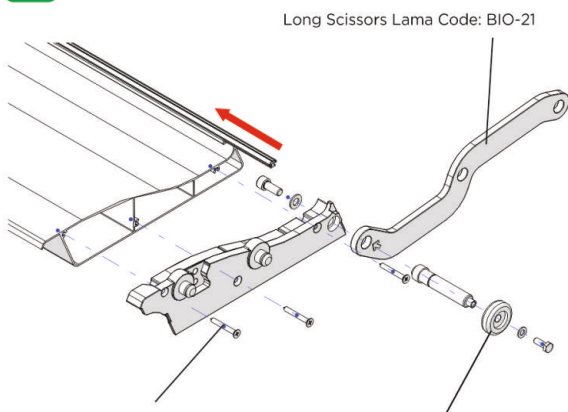

Long Scissors Lama Code: BIO-21

YHB SV 4.5x35 Screw

6005 Bearing Code: BIO-1-9 Standard

Panel (Long Scissors)

4

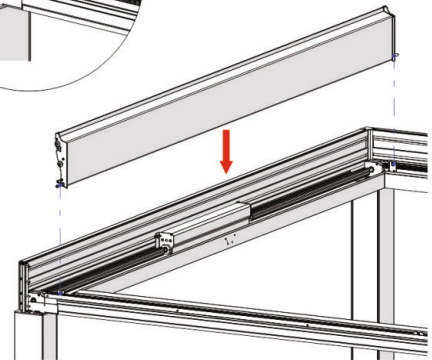
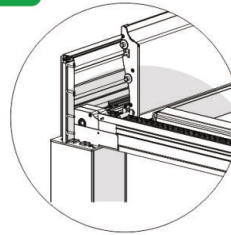

5

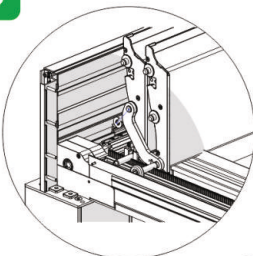

First, install the motor side fixed panel. Pay attention to the details in Detail 1.

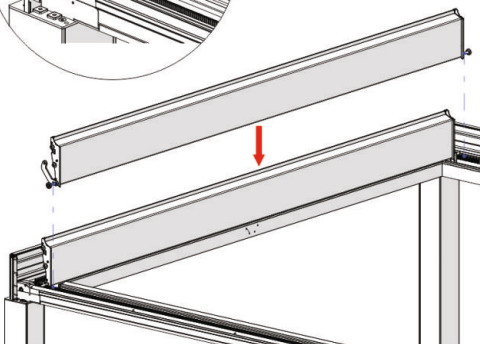

6

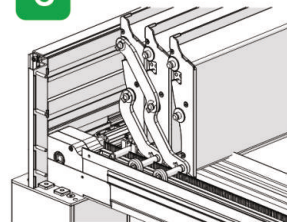

Secure the scissors together and fasten each one with the Scissors Ring Code: BIO-27.

Scissors Ring  
Code: BIO-27

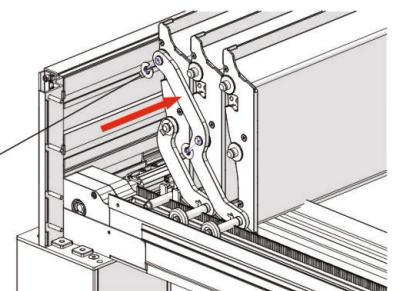

7

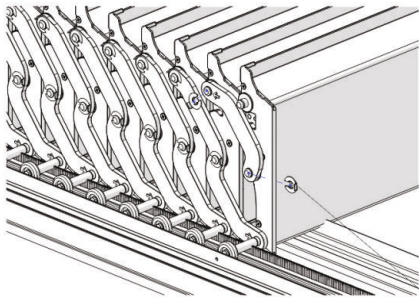

Scissors Ring Code: BIO-27

Continue the assembly by connecting the panels with the scissors rings.

8

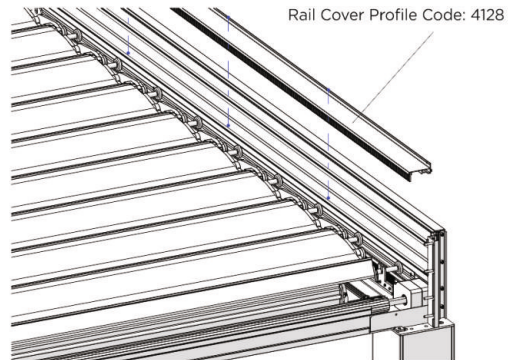

Rail Cover Profile Code: 4128

Continue the assembly by connecting the panels with the scissors rings.

9

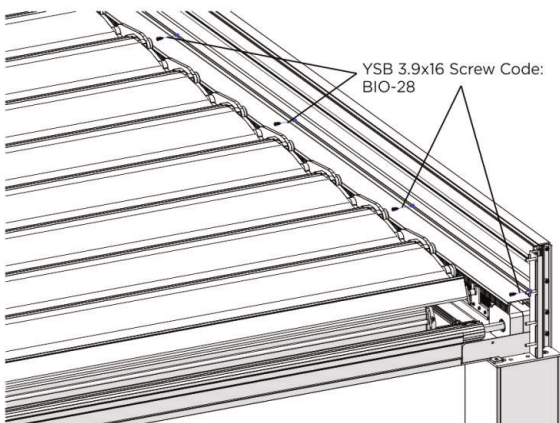

YSB 3.9x16 Screw Code: BIO-28

10

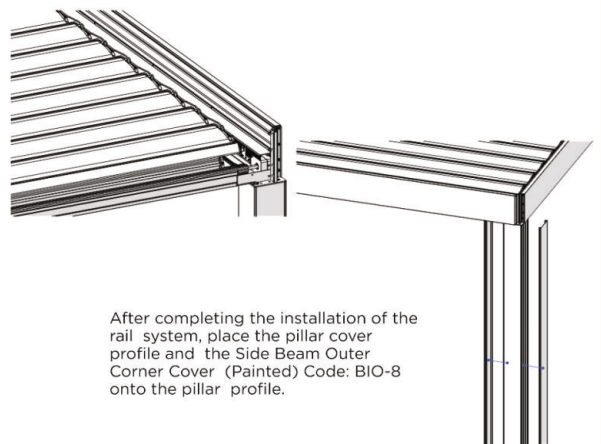

After completing the installation of the rail system, place the pillar cover profile and the Side Beam Outer Corner Cover (Painted) Code: BIO-8 onto the pillar profile.

11

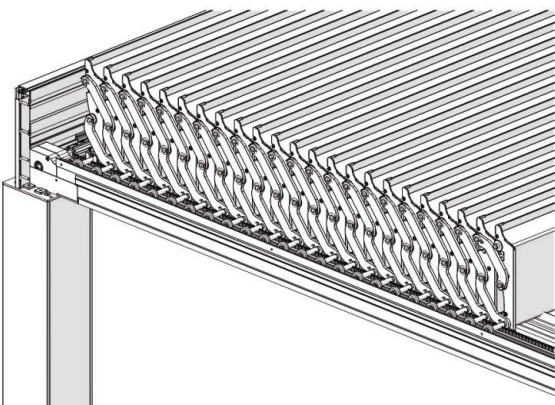

Secure the scissors together and fasten each one with the Scissors Ring Code: BIO-27.

12

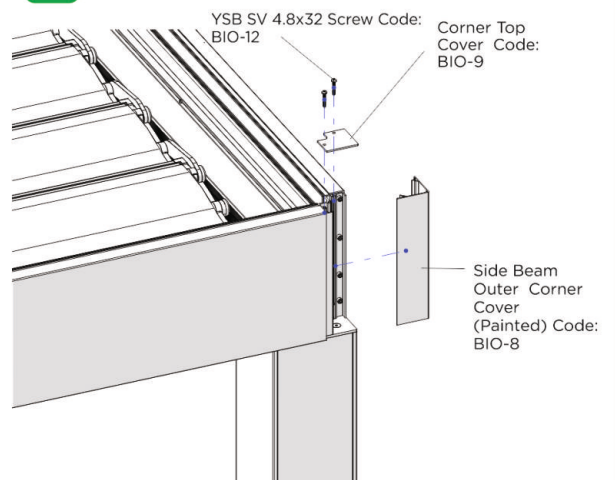

YSB SV 4.8x32 Screw Code: BIO-12

Corner Top Cover Code: BIO-9

Side Beam Outer Corner Cover (Painted) Code: BIO-8

1

Middle Connection  
Corner Apparatus  
Code: BIO-67

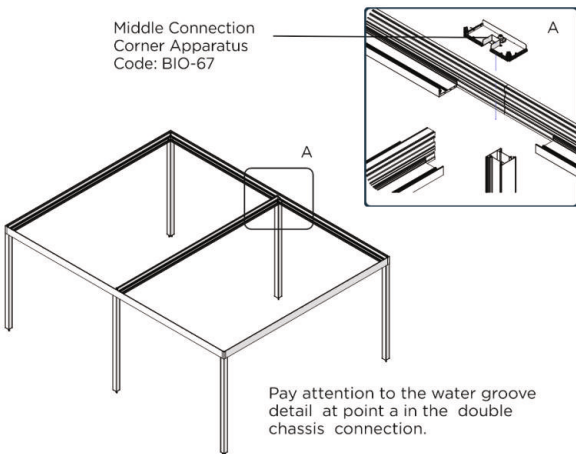

Pay attention to the water groove detail at point a in the double chassis connection.

2

Middle Connection  
Corner Apparatus  
Code: BIO-67

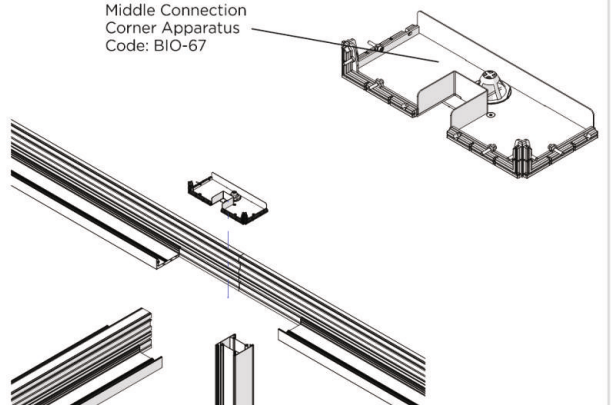

Place the connection apparatus on the pole part, secure it by tightening the bolts.

3

Middle Connection  
Corner Apparatus  
Code: BIO-67

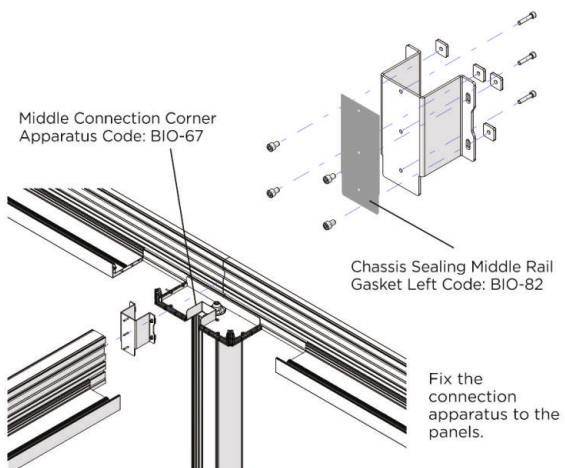

Chassis Sealing Middle Rail  
Gasket Left Code: BIO-82

Fix the  
connection  
apparatus to the  
panels.

4

Middle Connection  
Corner Apparatus  
Code: BIO-67

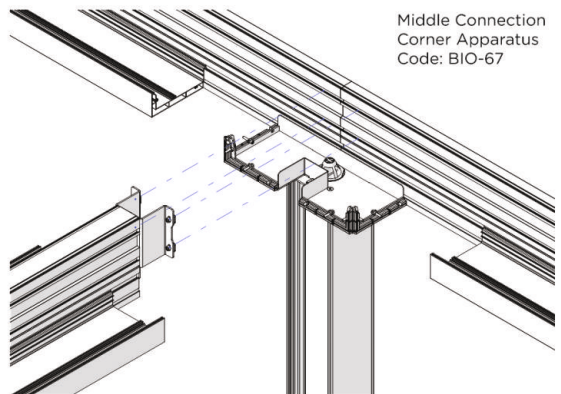

Place the connection apparatus on the pole part, secure it by tightening the bolts.

5

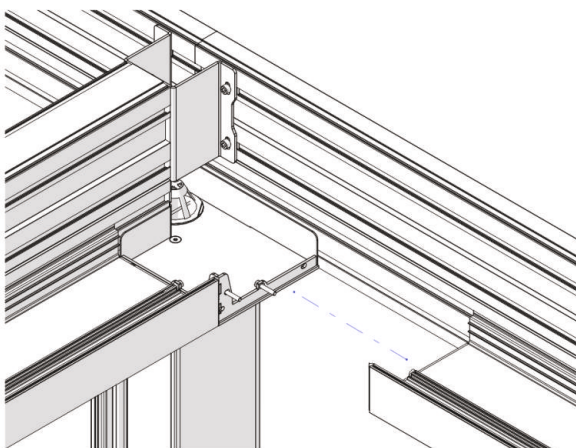

Align the square nuts on the panel and tighten them with an allen.

1

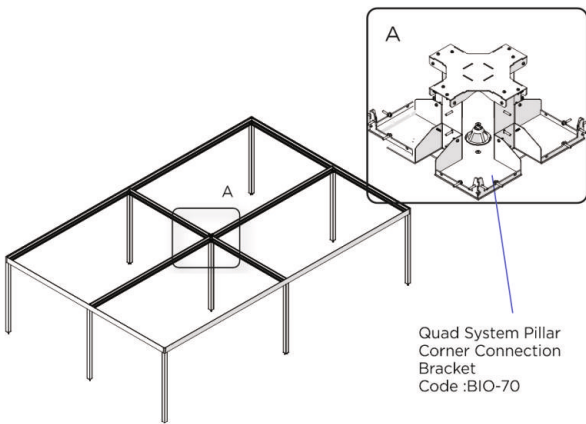

Quad System Pillar  
Corner Connection  
Bracket  
Code :BIO-70

In quad system, assemble the foot corner connection apparatus in detail a.

2

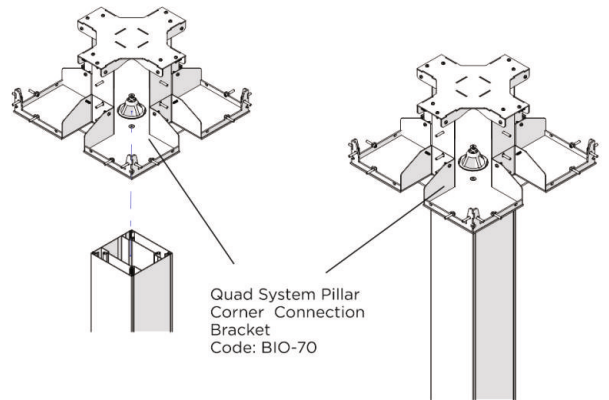

Quad System Pillar  
Corner Connection  
Bracket  
Code: BIO-70

Place the corner apparatus on the base and fix it.

3

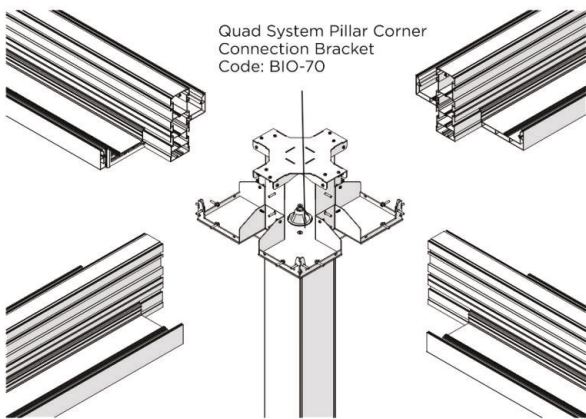

Quad System Pillar  
Corner Connection  
Bracket  
Code: BIO-70

Place the panels on the corner bracket so that they fit into the square nuts.

4

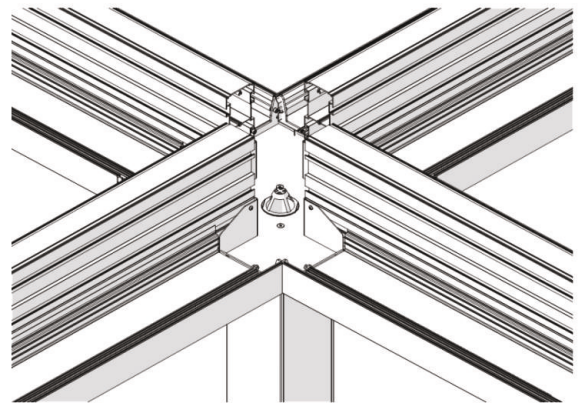

Collect and fix the profiles of the gutters on the central base column.

5



An intermediate base mount can be used to strengthen the system.

6

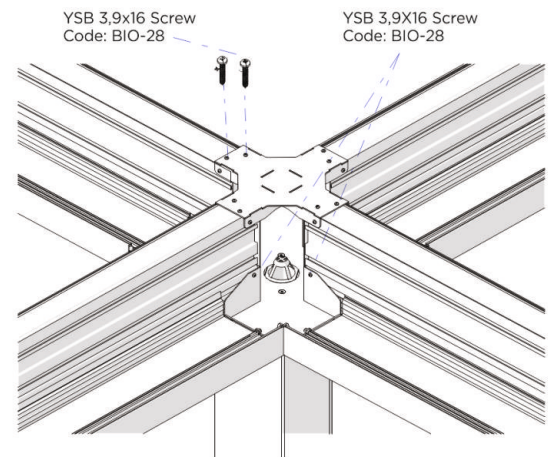

YSB 3,9x16 Screw  
Code: BIO-28

YSB 3,9x16 Screw  
Code: BIO-28

Base four-to-four top connection top apparatus code: BIO-3-6

## GUTTER BEAM PROFILE

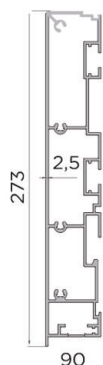

Product Code 4111  
Weight 5,721 kg/m

## MIDDLE GUTTER BEAM PROFILE

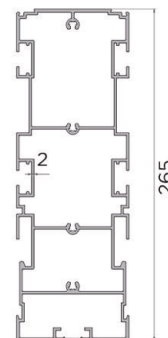
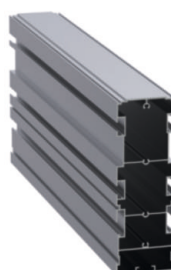

Product Code 4120  
Weight 7,366 kg/m

## GUTTER PROFILE

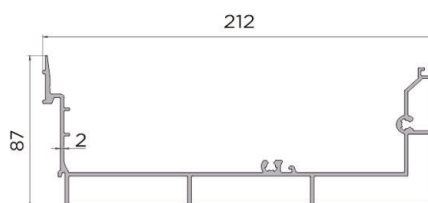
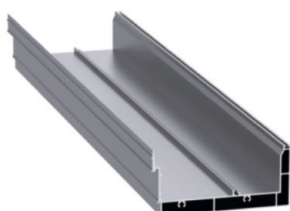

Product Code 4218  
Weight 3,940 kg/m

## PANEL PROFILE

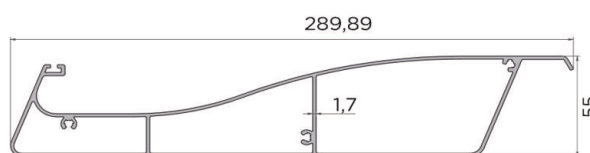
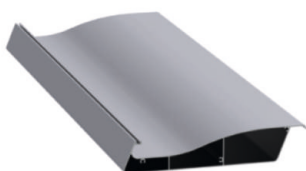

Product Code 4109  
Weight 3,553 kg/m

## PILLAR PROFILE

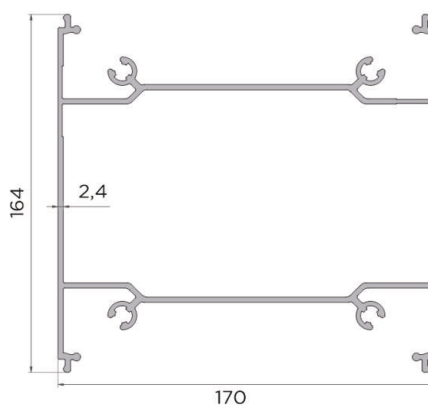
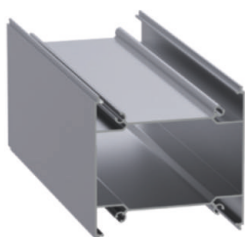

Product Code 4108  
Weight 5,368 kg/m

## PILLAR COVER PROFILE



Product Code 4122

Weight 1,309 kg/m

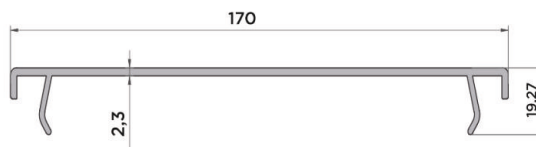

## LED PROFILE



Product Code 2953

Weight 0,445 kg/m

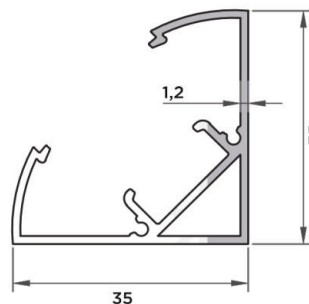

## GUTTER POST COVER



Product Code 4699

Weight 0,111 kg/m

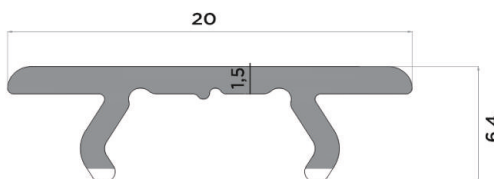

## RAIL COVER PROFILE

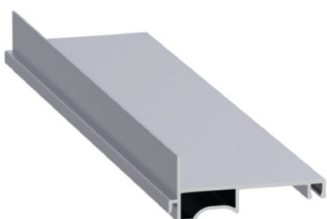

Product Code 4128

Weight 0,742 kg/m

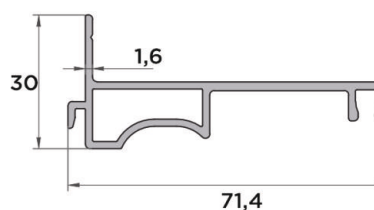

## RAIL PROFILE

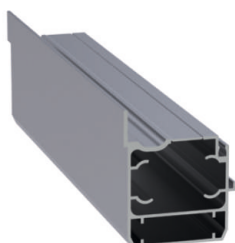

Product Code 4123

Weight 2,439 kg/m

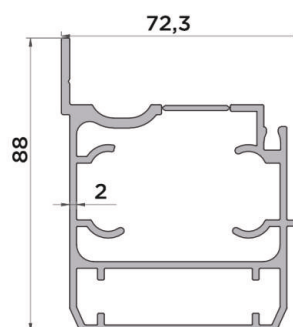

## MOTOR BOX PROFILE

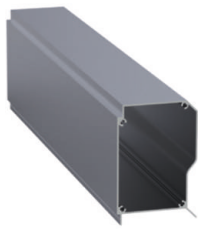

Product Code 4110  
Weight 2,317 kg/m

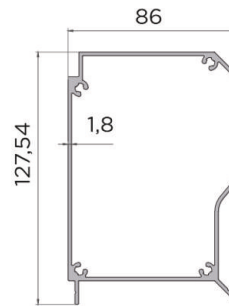

## MOTOR BOX PROFILE

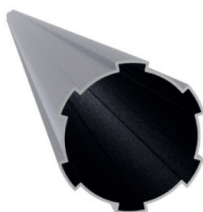

Product Code 37115  
Weight 0,992 kg/m

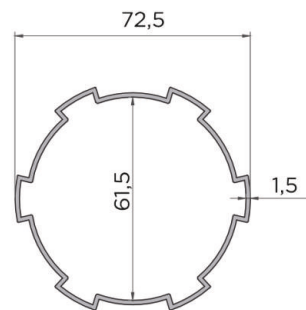

## SHAFT PROFILE

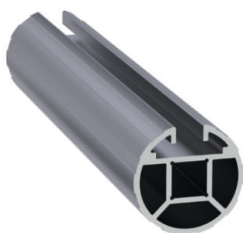

Product Code 4115  
Weight 1,417 kg/m

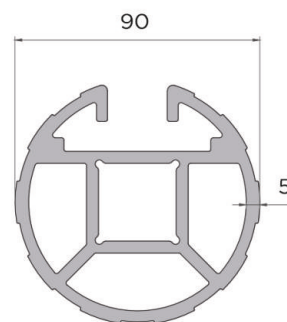

## TILT DRIVE PROFILE



Product Code 4118  
Weight 1,501 kg/m

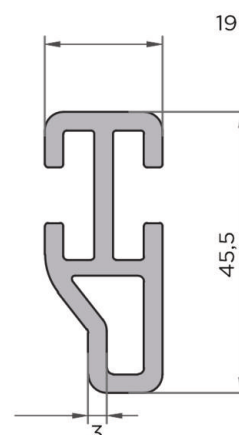

Middle Rail Wheel and Wheel Hinge



Code **BIO-17**

Pillar Top Connection Apparatus (Paintable)

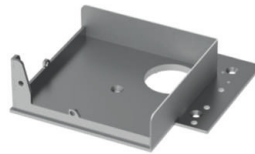

Code **BIO-6**

Leg Upper Connection Apparatus Without Water Outlet



Code **BIO-6-1**

Corner Joint Top Connection Without Water Outlet (Paintable)

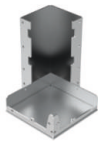

Code **BIO-16-1**

Middle Connection Corner Apparatus

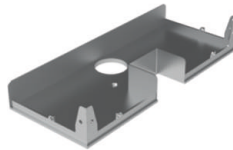

Code **BIO-67**

Corner Joint Apparatus Without Water Outlet (Paintable)

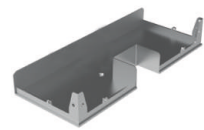

Code **BIO-67-1**

Quad System Pillar Corner Connection Bracket



Code **BIO-70**

Quad System Pillar Corner Connection Bracket Without Water Outlet

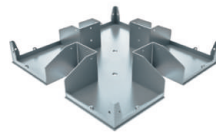

Code **BIO-70-1**

Quad System Pillar Top Connection Plate



Code **BIO-71**

Corner Top Cover

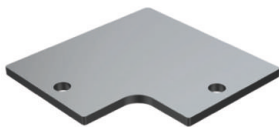

Code **BIO-9**

Side Beam Inter Corner Connection (Painted)



Code **BIO-7**

Quad Chassis Binary Profile End Closure Plate



Code **BIO-8**

Corner Joint Top Connection (Paintable)

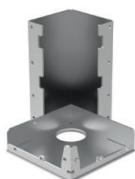

Code **BIO-16**

Middle Connection Profile Connection Apparatus



Code **BIO-68**

Quad Chassis Binary Profile End Closure Plate



Code **BIO-75**

Middle Rail Connection Laser



Code **BIO-G17-1**

Hidden Wall Connection Apparatus



Code **BIO-72**

Wall Connection Apparatus



Code **BIO-73**

Lower Wall Connection Apparatus



Code **BIO-74**

Hidden Place Connection Apparatus



Code **BIO-18**

Gutter Gasket / Right



Code **BIO-19**

Panel Wick

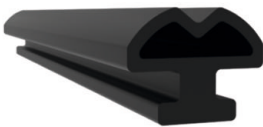

Code **BIO-25**

T10-16mm Timing Belt



Code **PRG-105**

75 mm Water Drainage With Sieve



Code **KIS-08Y**

Chassis Sealing Middle Rail Gasket Right



Code **BIO-82-1**

Chassis Sealing Middle Rail Gasket Left



Code **BIO-81**

LED Corner Plastic

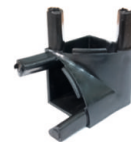

Code **ROLL-24**

Isolated LED Daylight



Code **PAL-145**

YHB 4,8x38 Screw



Code **BIO-11**

HB 08x35 Bolt



Code **BIO-13**

Chassis Sealing Gasket Right



Code **BIO-81-1**

Gutter Gasket / Left



Code **BIO-20**

Gutter Seal

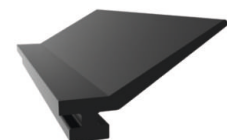

Code **BIO-26**

Chassis Sealing Gasket Left



Code

**BIO-81**

Motor Box Shaft



Code

**BIO-31**

Short Scissors Lama



Code

**BIO-22**

Scissors Rail Set



Code

**BIO-1**

Scissors Motor Set



Code

**BIO-2**

Scissors Wheel Set



Code

**BIO-3**

Panel Cover Right



Code

**BIO-4**

Panel Cover Left



Code

**BIO-5**

Long Scissors Lama



Code

**BIO-21**

Tubular Motor



Code

**RTS-120**  
1 PCS

Brush



Code

**BIO-24**

Lighting Box Somfy  
(Transformer + Dimmer)

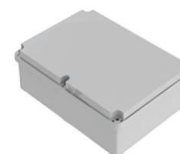

Code

**BIO-32**

Pillar Top Connection  
Apparatus (Paintable)

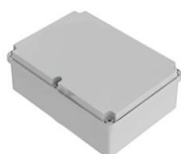

Code

**BIO-34**

Motor Switch Ring



Code

**PRG-151**

Somfy Motor Bracket



Code

**PAL-140**

Scissors Ring



Code

**BIO-27**

M8X12 Allen Bolt



Code

**BIO-15**

M8x20 Allen Bolt



Code

**BIO-54**

YSB 3,9x16 Screw



Code

**BIO-28**

M8x16 AKB Bolt



Code

**BIO-29**

M8 25x25 Lama



Code

**BIO-10**

Lighting Unit Daylight  
(Transformer + Dimmer + Control)

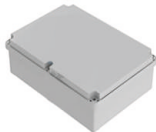

Code

**BIO-33**

Guillotine Somfy Motor Apparatus



Code

**GYT-26-1**

M8 Washer



Code

**BIO-55**

Motor Set



Code **BIO-36**

Panel Drive Set



Code **BiO-37**

Panel Cover - Right



Code **BIO-38**

Motor Panel Shaft



Code **BIO-43**

Plastic Adjustment Distance Template

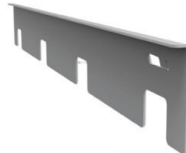

Code **BIO-G78**

Lighting Box Somfy (Transformer + Dimmer)

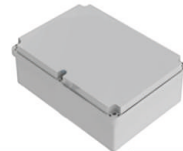

Code **BIO-62**

Pillar Top Connection Apparatus (Paintable)

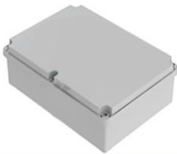

Code **BIO-64**

M8 Washer



Code **BIO-42**

M8 25x25 Lama



Code **BIO-10**

M8x12 Inbus Bolt



Code **BIO-15**

YHB 4,8x18 Screw



Code **BIO-11**

M8x25 Allen Bolt



Code **BIO-41**

Lighting Unit Daylight  
(Transformer + Dimmer + Control)



Code **BIO-39**

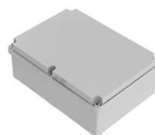

Code **BIO-63**

M8x20 Allen Bolt



Code **BIO-54**

M6x30 Allen Bolt



Code **BIO-14**



**SPS BIOCLIMATIC**

# PERGOLA SYSTEM

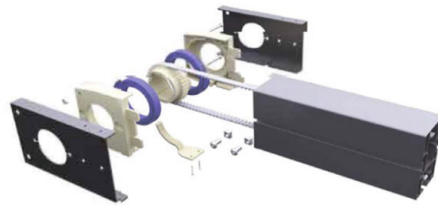
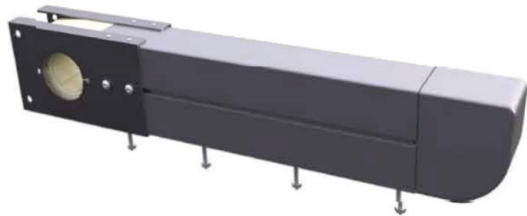
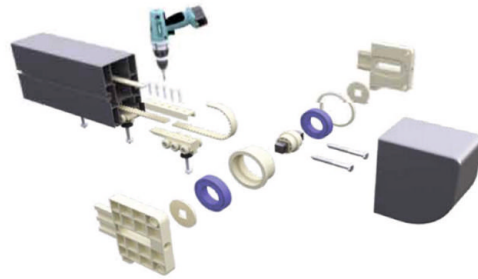
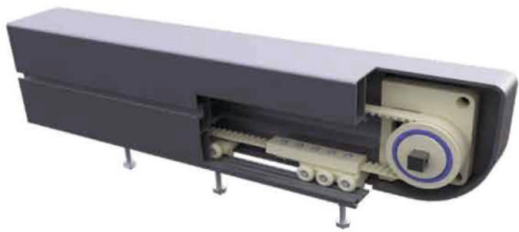

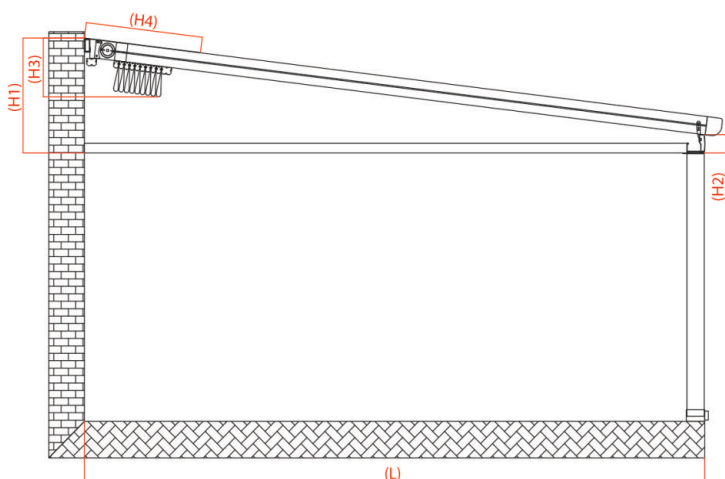
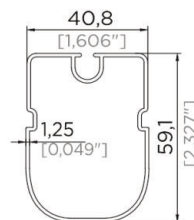
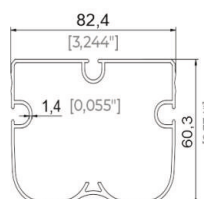
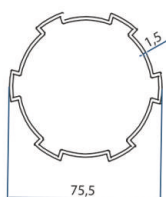
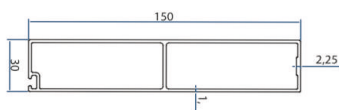
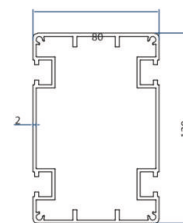
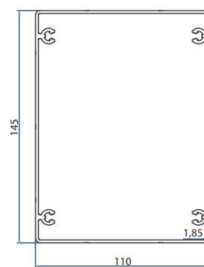
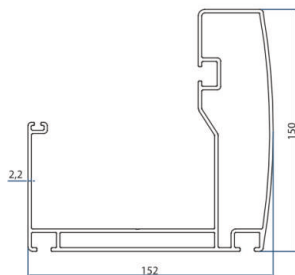
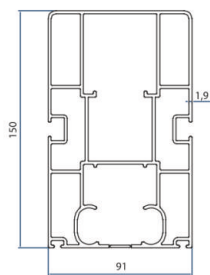

(L)	(H1)	(H2)	(H3)	(H4)	
300 cm	68 cm	15 cm	50 cm	56 cm	5+2
350 cm	74 cm		51 cm	56 cm	5+2
400 cm	80 cm		52 cm	65 cm	7+2
450 cm	86 cm		53 cm	65 cm	7+2
500 cm	92 cm		54 cm	74 cm	9+2
550 cm	99 cm		55 cm	74 cm	9+2
600 cm	105 cm		56 cm	83 cm	11+2
650 cm	111 cm		57 cm	83 cm	11+2
700 cm	117 cm		58 cm	92 cm	13+2

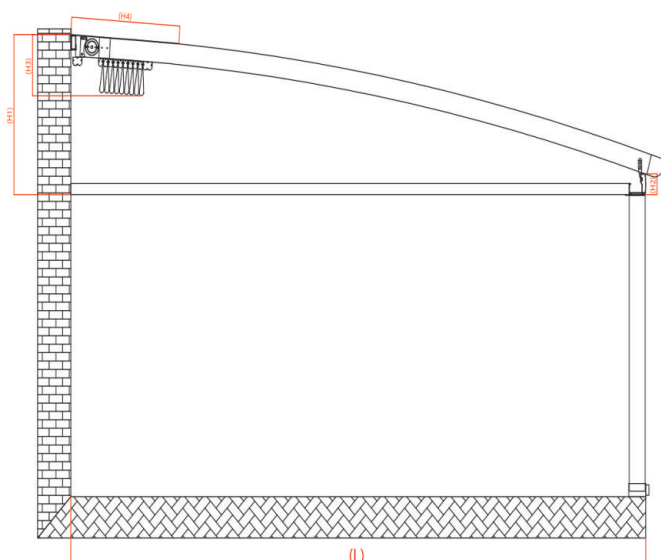

(L)	(H1)	(H2)	(H3)	(H4)	
300 cm	75 cm	15 cm	50 cm	56 cm	5+2
350 cm	85 cm		51 cm	56 cm	5+2
400 cm	95 cm		52 cm	65 cm	7+2
450 cm	105 cm		53 cm	65 cm	7+2
500 cm	115 cm		54 cm	74 cm	9+2
550 cm	125 cm		55 cm	74 cm	9+2
600 cm	135 cm		56 cm	83 cm	11+2
650 cm	145 cm		57 cm	83 cm	11+2
700 cm	155 cm		58 cm	92 cm	13+2
750 cm	165 cm		59 cm	92 cm	13+2
800 cm	175 cm	60 cm	100 cm	15+2	

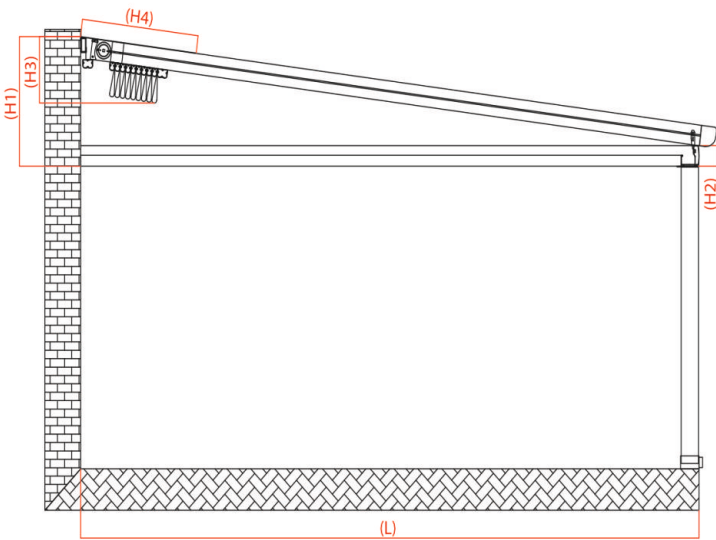
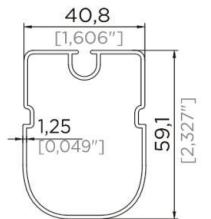
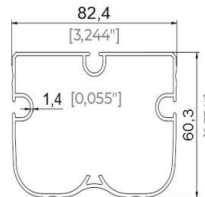
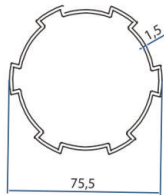
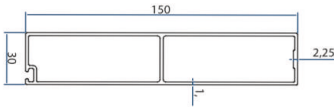
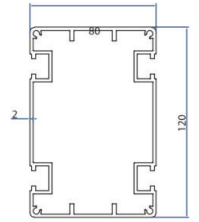
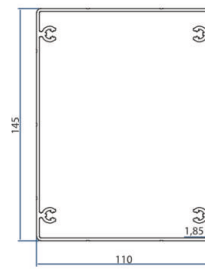
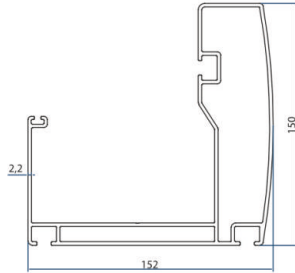
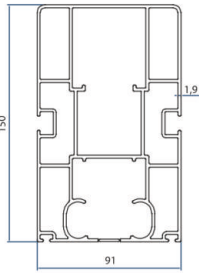

(L)	(H1)	(H2)	(H3)	(H4)	
300 cm	68 cm	15 cm	50 cm	56 cm	5+2
350 cm	74 cm		51 cm	56 cm	5+2
400 cm	80 cm		52 cm	65 cm	7+2
450 cm	86 cm		53 cm	65 cm	7+2
500 cm	92 cm		54 cm	74 cm	9+2
550 cm	99 cm		55 cm	74 cm	9+2
600 cm	105 cm		56 cm	83 cm	11+2
650 cm	111 cm		57 cm	83 cm	11+2
700 cm	117 cm		58 cm	92 cm	13+2
750 cm	123 cm		59 cm	92 cm	13+2
800 cm	130 cm		60 cm	100 cm	15+2
850 cm	136 cm		61 cm	100 cm	15+2
900 cm	142 cm		62 cm	110 cm	17+2
950 cm	148 cm		63 cm	110 cm	17+2
1000 cm	155 cm		64 cm	120 cm	19+2
1050 cm	161 cm		65 cm	120 cm	19+2
1100 cm	167 cm		66 cm	130 cm	21+2
1150 cm	173 cm		67 cm	130 cm	21+2
1200 cm	179 cm	68 cm	140 cm	23+2	

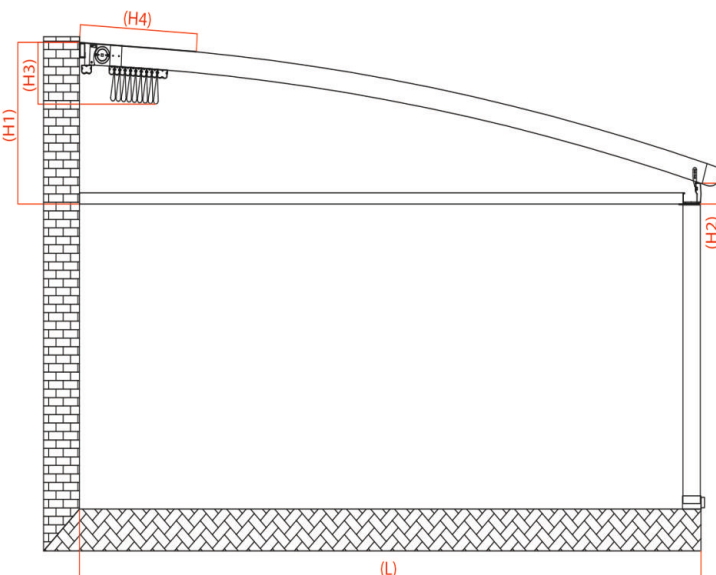

(L)	(H1)	(H2)	(H3)	(H4)	
300 cm	75 cm	15 cm	50 cm	56 cm	5+2
350 cm	85 cm		51 cm	56 cm	5+2
400 cm	95 cm		52 cm	65 cm	7+2
450 cm	105 cm		53 cm	65 cm	7+2
500 cm	115 cm		54 cm	74 cm	9+2
550 cm	125 cm		55 cm	74 cm	9+2
600 cm	135 cm		56 cm	83 cm	11+2
650 cm	145 cm		57 cm	83 cm	11+2
700 cm	155 cm		58 cm	92 cm	13+2
750 cm	165 cm		59 cm	92 cm	13+2
800 cm	175 cm		60 cm	100 cm	15+2
850 cm	185 cm		61 cm	100 cm	15+2
900 cm	195 cm		62 cm	110 cm	17+2
950 cm	205 cm		63 cm	110 cm	17+2
1000 cm	215 cm		64 cm	120 cm	19+2
1050 cm	225 cm		65 cm	120 cm	19+2
1100 cm	235 cm		66 cm	130 cm	21+2
1150 cm	245 cm		67 cm	130 cm	21+2
1200 cm	255 cm	68 cm	140 cm	23+2	

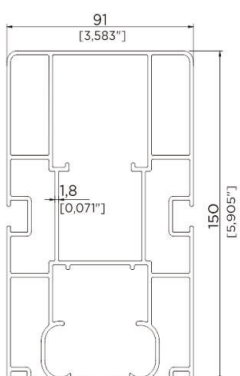
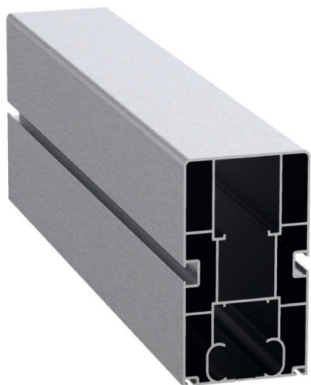

**91X150 RAL PROFILE**

Product Code	2052
Weight	4,867 kg/m 10,73 lb/m



**152X150 GUTTER PROFILE**

Product Code	2078
Weight	4,255 kg/m 9,315 lb/m

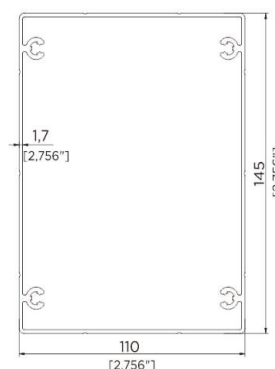
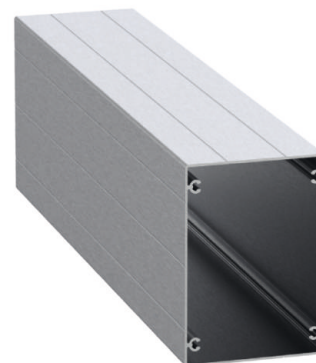

**110X145 PILLAR PROFILE**

Product Code	2111
Weight	2,837 kg/m 6,255 lb/m

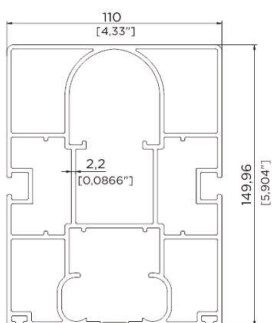
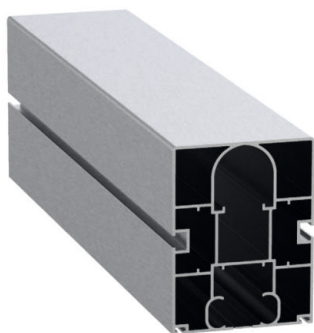

**110X150 RAIL PROFILE**

Product Code	2001
Weight	6,574 kg/m 14,493 lb/m

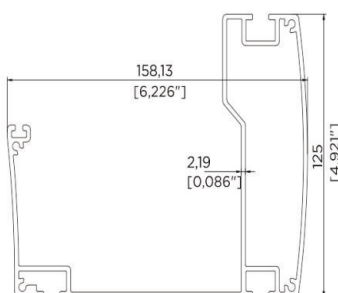
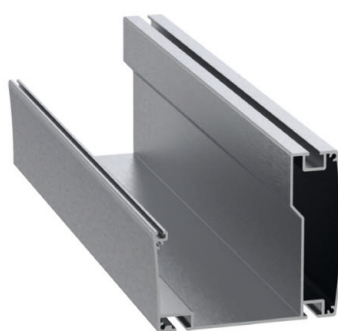

**158X125 GUTTER PROFILE**

Product Code	5935
Weight	3,721 kg/m 8,203 lb/m

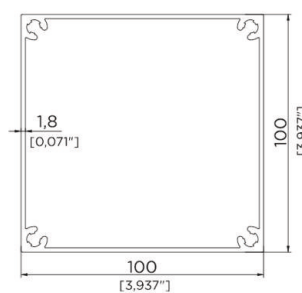
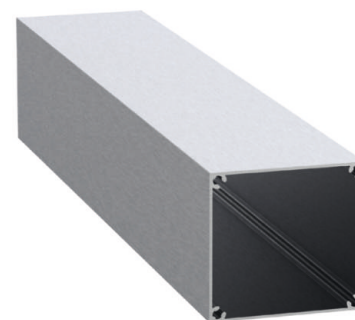

**100X100 PILAR PROFILE**

Product Code	6565
Weight	2,287 kg/m 5,042 lb/m

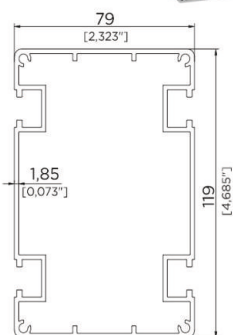
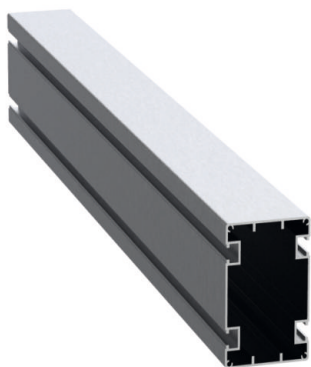

**HORIZONTAL PROFILE**

Product Code	5936
Weight	2,726 kg/m 6,01 lb/m

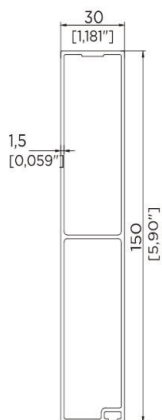

**30X150 BOX PROFILE**

Product Code	37025
Weight	1,607 kg/m 3,543 lb/m

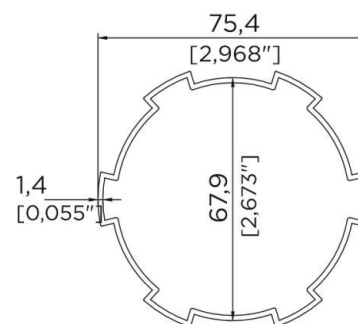

**MOTOR TUBE**

Product Code	5312
Weight	1,000 kg/m 2,205 lb/m

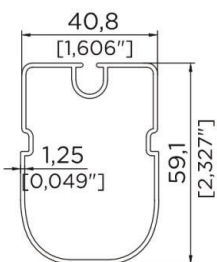

**40,8X59,1 FABRIC SUPPORT PROFILE**

Product Code	2653
Weight	0,697 kg/m 1,537 lb/m

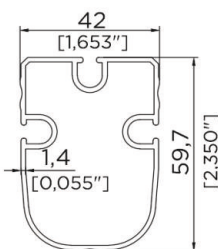

**42X59,7 FABRIC SUPPORT PROFILE**

Product Code	37153
Weight	0,935 kg/m 2,061 lb/m

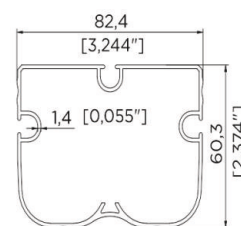

**82,4X60,3 FABRIC SUPPORT PROFILE**

Product Code	37216
Weight	1,280 kg/m 2,822 lb/m

## Pergola Rail Group Code: PRG-23

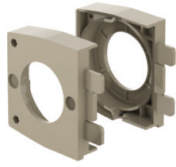

Back Cage

Code Piece **PRG-01**  
30



Rear Gear

Code Piece **PRG-02**  
30



Break

Code Piece **PRG-03**  
30



Front Tensioner Wedge  
Right/Left

Code Piece **PRG-04**  
30



Small Bearing Cage

Code Piece **PRG-05**  
30

## Pergola Cornice Group



Thick Cornice Cover

Code Piece **PRG-10**  
40



Thin Cornice Cover

Code Piece **PRG-11**  
160



Fabric Tension Plastic

Code Piece **PRG-12**  
200



Dowel

Code Piece **PRG-13**  
300

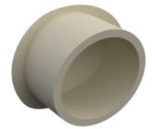

Cover

Code Piece **PRG-14**  
300

## Pergola Wheel Group Code: PRG-25



Timing Connection

Code Piece **PRG-15**  
30



Big Car

Code Piece **PRG-12**  
200



Small Car

Code Piece **PRG-17**  
240

## Pergola Plastic Accessories

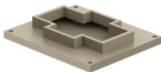

80x120 Plastic Under Pillar and Gasket

Code Piece **PRG-06**  
50



Universal Pergola Engine Apparatus

Code Piece **PRG-26**  
100



Tubular Motor Switch Plastic

Code Piece **PRG-151**  
100



Water Drainage

Code Piece **PRG-09**  
100



70 mm Water Drainage With Sieve

Code Piece **PRG-08Y**  
50



Somfy Pergola Motor Apparatus

Code Piece **PRG-18**  
50



Code Piece **PRG-08**  
40

Cream PRG-06  
A.Gray PRG-06-1  
/Black PRG-06-2  
White PRG-06-3

Cream PRG-09  
A.Gray PRG-09-1  
/Black PRG-09-2  
White PRG-09-3

Cream PRG-08  
A.Gray PRG-08-2  
White PRG-08-3  
/Black PRG-08-4

## Pergola Plastic Accessories



Thin Cornice Corner Wedge

Code Piece **PRG-19**  
150



Thin Cornice Center Wedge

Code Piece **PRG-20**  
100

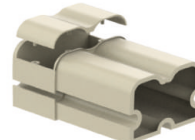

Thick Cornice Corner Wedge

Code Piece **PRG-21**  
100

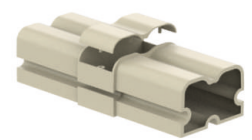

Thick Cornice Center Wedge

Code Piece **PRG-22**  
100

## Pergola Metal Accessories



110x150 Rail Wall Hanger Sheet

Code Piece **PRG-40**  
50



90x150 Rail Wall Hanger Sheet

Code Piece **PRG-41**  
50



90x150 and 110x150 Rail Back Connection Sheet

Code Piece **PRG-42**  
50



90x150 and 110x150 Rail Back Thick Cornice Fixing Sheet

Code Piece **PRG-43**  
50



90x150 and 110x150 Rail Motor Fixing Sheet

Code Piece **PRG-44**  
50

Can be painted

Can be painted

Can be painted

Can be painted

Can be painted

## Pergola Metal Accessories



70/90/110 Rail Large Gutter Connection Sheet

Code Piece **PRG-46**  
50

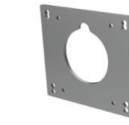

110x145 Pillar Gutter Connection Sheet

Code Piece **PRG-48**  
50



70 Rai Wall Hanger Connection Sheet PRG-49 50

Code Piece **PRG-49**  
50



70 Rail Back Thick Cornice Fixing Sheet

Code Piece **PRG-50**  
50

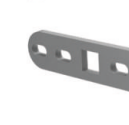

70 Rail Motor Fixing Sheet

Code Piece **PRG-51**  
50



70 Rail Back Perforated Connection Sheet

Code Piece **PRG-52**  
50

## Pergola Metal Accessories



70 Rail Back Connection Sheet Without Hole

Code Piece **PRG-53**  
50



Small Gutter 70/90/110 Rail Connection Sheet

Code Piece **PRG-54**  
50



Small Gutter Cover (5935)

Code Piece **PRG-55**  
50



80x120 Pillar Small Gutter Top Connection Sheet

Code Piece **PRG-56**  
50



80x120 Pillar Lower Perforated Connection Sheet

Code Piece **PRG-57**  
50



80x120 Pillar Lower Connection Sheet

Code Piece **PRG-58**  
50

## Pergola Metal Accessories



Trapeze Connection Sheet

Code Piece **PRG-59**  
50



100x100 Pillar Connection Sheet

Code Piece **PRG-60**  
50



110x145 Covered Pillar Gutter Sheet

Code Piece **PRG-61**  
50



110x145 Covered Pillar Ground Connection Sheet

Code Piece **PRG-62**  
50



120x150 Pillar Gutter Connection Sheet

Code Piece **PRG-63**  
50



Glass Slide

Code Piece **PRG-69**  
50

## Pergola Metal Accessories

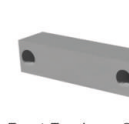

Front Tensioner Square Automat(16x16)

Code Piece **PRG-79**  
100



110x150 Rail Front Cover

Code Piece **PRG-80**  
16



90x150 Rail Front Cover

Code Piece **PRG-81**  
30



70x150 Rail Front Cover

Code Piece **PRG-82**  
38

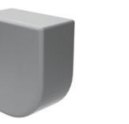

100x100 Pillar Lower Shoe

Code Piece **PRG-83**  
36

## Pergola Metal Accessories



110x145 Pillar Lower Shoe

Code Piece **PRG-84**  
25



120x150 Pillar Lower Shoe

Code Piece **PRG-85**  
15



Gutter (2078) Casting Cover

Code Piece **PRG-86**  
40



Gutter(3263) Casting Cover PRG-65

Code Piece **PRG-65**  
60

## Pergola Accessories

For 16 Belt



Large Bearing Plastic

Code Piece **PRG-117**  
50

For 25 Belt



Large Thin Bearing Plastic PRG-118 50

Code Piece **PRG-118**  
50

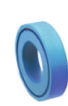

Small Bearing Plastic

Code Piece **PRG-119**  
200

## Pergola Accessories



24W Horizontal Led Daylight

Code Piece **PRG-108**



24W Horizontal Led White

Code Piece **PRG-109**



24W Led Embed Daylight

Code Piece **PRG-110**



24W Led Embed White

Code Piece **PRG-111**



70x150 Pergola Bolt Set

Code Piece **PRG-120**



90x150 Pergola Bolt Set

Code Piece **PRG-121**

## Pergola Accessories



ERS Led Dimmer

Code Piece **ERS-LC**



Somfy Led Dimmer

Code Piece **PRG-70**



24W Led Transformer 5 Ampere

Code Piece **PRG-113**



24W Led Transformer 10 Ampere

Code Piece **PRG-114**



24W Led Transformer 15 Ampere

Code Piece **PRG-115**

## Pergola Seals And Triger Belt Accessories

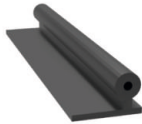

Fabric Wick (Edge) 100 meters

Code Piece **PRG-100**



PRG-100-F = Fabric Wick (Edge Frequency Machine Compatible) (2300) PRG-100F-2 = Fabric Wick from the Edge (Compatible with 2nd Frequency Machine) (2302) PRG-100F-3 = Fabric Wick from the Edge (Frequency Machine Compatible) (2304)

Code Piece **PRG-100-F**

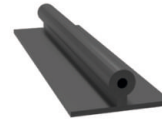

Fabric Wick (Middle) 100 meters

Code Piece **PRG-101**

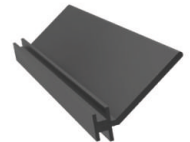

Rail Wick 100 meters

Code Piece **PRG-102**

## Pergola Seals And Triger Belt Accessories

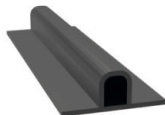

Cable Wick 100 meters

Code Piece **PRG-103**



Gutter Wick 75 meters

Code Piece **PRG-104**

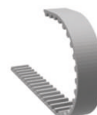

T10x16 Timing Belt 100 meters

Code Piece **PRG-105**



T10x25 Timing Belt 100 meters

Code Piece **PRG-107**

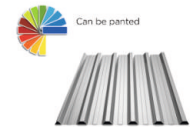

Trapezo Idal Sheet

Code Piece **PRG-99**





**SPS BIOCLIMATIC**

# GUILLOTINE GLASS SYSTEMS

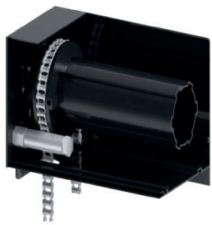
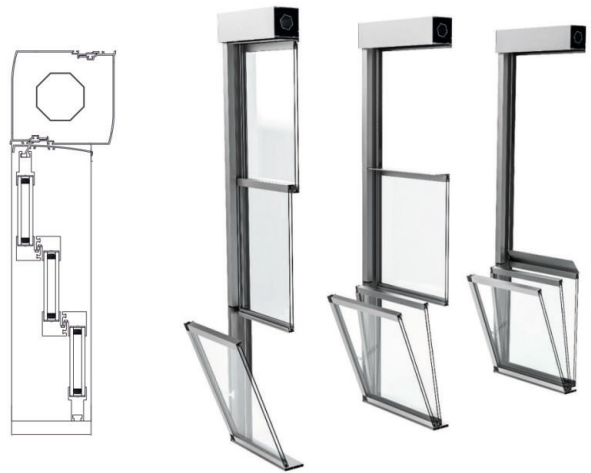
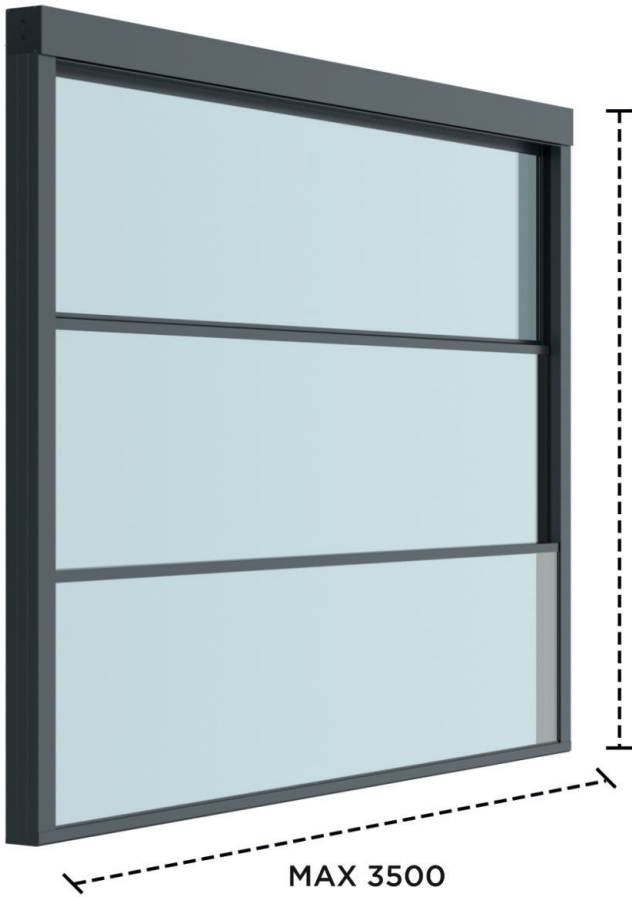

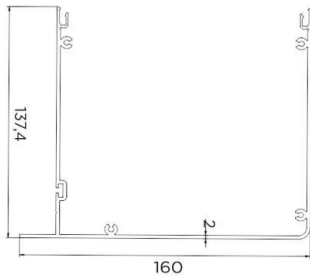

**MOTOR BOX PROFILE**

Product Code	37272
Weight	2,699 kg/m 5,950 lb/m

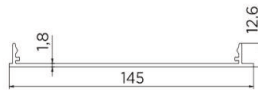
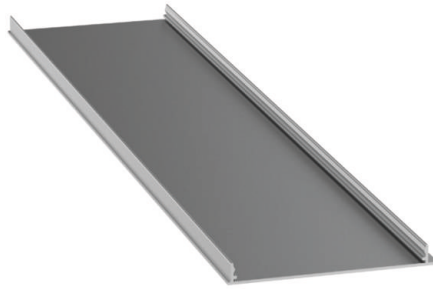

**MOTOR BOX COVER PROFILE**

Product Code	37271
Weight	0,874 kg/m 1,867 lb/m

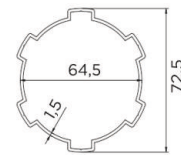

**MOTOR TUBE PROFILE**

Product Code	37115
Weight	0,992 kg/m 2,187 lb/m

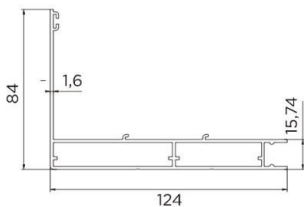

**SIDE RAIL PROFILE**

Product Code	37267
Weight	1,624 kg/m 3,580 lb/m

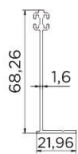

**RAIL MIDDLE PROFILE**

Product Code	37268
Weight	0,466 kg/m 1,027 lb/m

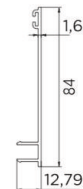
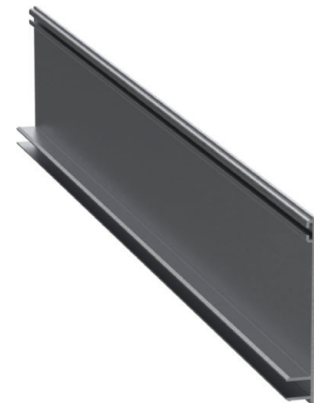

**SIDE RAIL COVER PROFILE**

Product Code	37269
Weight	0,477 kg/m 1,052 lb/m

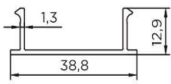

**RAIL COVER PROFILE**

Product Code	37270
Weight	0,230 kg/m 0,507 lb/m

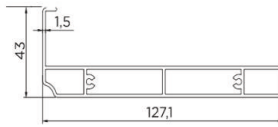
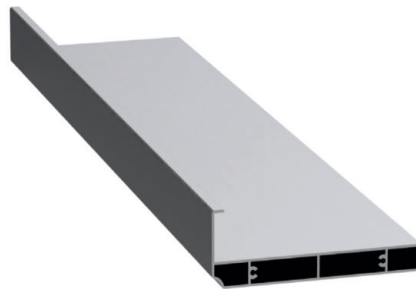

**SILL PROFILE**

Product Code	37266
Weight	1,485 kg/m 3,274 lb/m

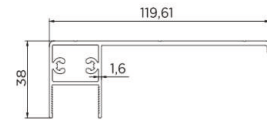

**24MM GLASS HANDRAIL PROFILE**

Product Code	37265
Weight	1,285 kg/m 2,833 lb/m

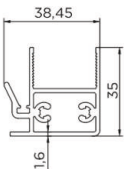

**24MM GLASS PULLER PROFILE**

Product Code	37264
Weight	0,818 kg/m 1,803 lb/m

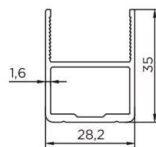

**24MM GLASS FRAME PROFILE**

Product Code	37263
Weight	0,545 kg/m 1,202 lb/m

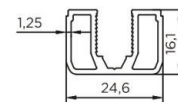

**8MM GLASS ADAPTER**

Product Code	37281
Weight	0,353 kg/m 0,778 lb/m

## Guillotine Accessories Chain set Code: GYT-01



Guillotine Motor Box Cover

Code Piece **GYT-07**  
2



Lower Base Plastic

Code Piece **GYT-06**  
2



Handrail Plastic Cover

Code Piece **GYT-10**  
2



Corner Wedge

Code Piece **GYT-11**  
2



Sprocket

Code Piece **GYT-12**  
2



Chain 5 meters

Code Piece **GYT-19**  
-



Chain Connection

Code Piece **GYT-13**  
2

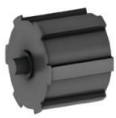

Pipe Head

Code Piece **GYT-14**  
1



3,9\*22 YHB Screw

Code Piece - **8**



4,8\*16 YHB Screw

Code Piece - **24**



4,8\*60 YHB Screw

Code Piece - **24**



M6\*25 HB Imbus Bolt

Code Piece - **2**



M3 Fiber Nut

Code Piece - **2**



M3\*25 Imbus Bolt

Code Piece - **2**

## Guillotine Accessories Strapped set Code: GYT-02



Guillotine Motor Box Cover

Code Piece **GYT-07**  
2



Lower Base Plastic

Code Piece **GYT-06**  
2



Corner Cover

Code Piece **GYT-10**  
2



Timing Pulley

Code Piece **GYT-15**  
12



Pulley Belt Compression T-Sheet

Code Piece **GYT-22**  
4



Belt Connector Pin T-sheet Code

Code Piece **GYT-23**  
2



Belt Under Compression

Code Piece **GYT-24**  
4



Belt Bottom Stopping

Code Piece **GYT-25**  
2



Corner Wedge

Code Piece **GYT-11**  
12

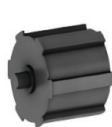

Pipe Head T

Code Piece **GYT-14**  
1



3,9\*22 YHB Screw

Code Piece - **8**



4,8\*16 YHB Screw

Code Piece - **24**



4,8\*60 YHB Screw

Code Piece - **24**



M6\*22 HB Imbus Bolt

Code Piece - **2**

## Guillotine Accessories



T3\_F20 Guillotine Belt

Code 1 Roll **GYT-21**  
100 m

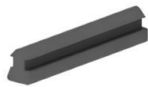

Clamped Profile Bolt

Code 1 Roll **GYT-27**  
300 m



Motor Box Bolt

Code 1 Roll **GYT-10**  
75 m



67\*800 Bristle Wick

Code 1 Roll **GYT-15**  
250 m



Guillotine Somp Motor Apparatus

Code Piece **GYT-22**  
1



Guillotine Becker Motor Apparatus

Code Piece **GYT-26-2**  
1



Guillotine Universal Motor Apparatus

Code Piece **GYT-26-3**  
1



Motor Switch Ring

Code Piece **PRG-151**  
1



**SPS BIOCLIMATIC**

**SLIDING SYSTEM**



1

3-SYSTEM JUNCTION DETAIL

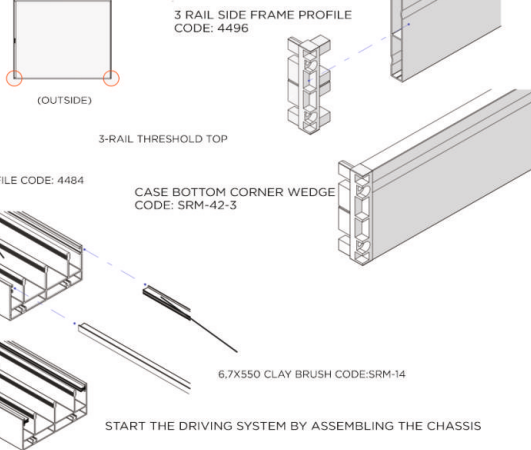

2

3-SYSTEM JUNCTION DETAIL

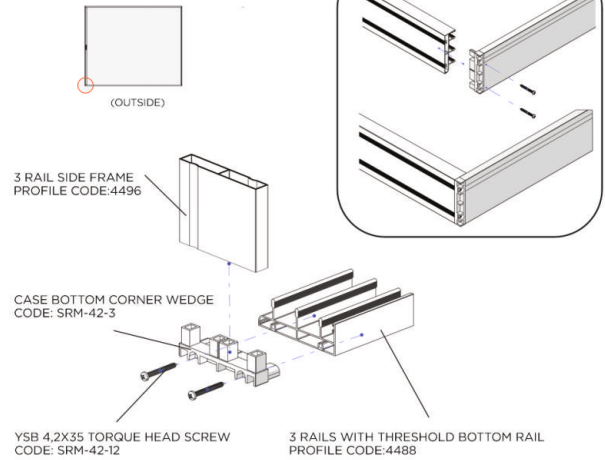

3

6-SYSTEM JUNCTION DETAIL

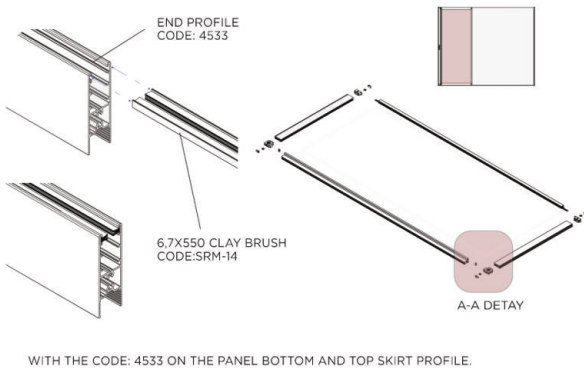

4

SINGLE HANDLE WING PROFILE CODE: 4570

END PROFILE (BOTTOM-TOP) CODE: 4533

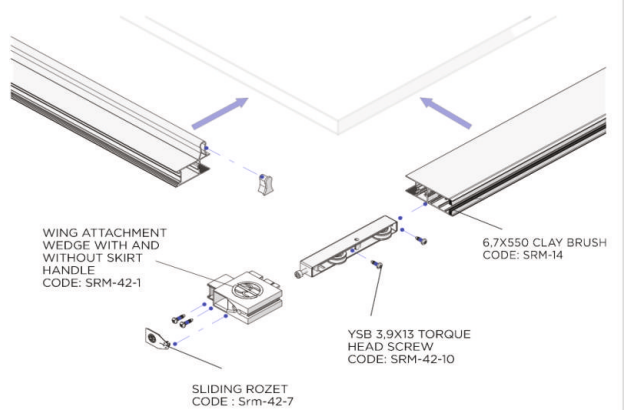

5

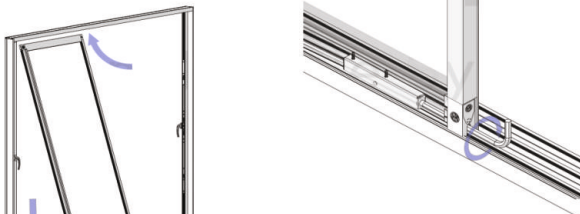

IN THE ASSEMBLY OF THE PANELS, PLACE THE SCREW OF THE GLASS PANEL BOTTOM PROFILE THEN PLACE THE SLIDING WHEEL DOUBLE BOTTOM APPARATUS AND SCREW IT.

6

(OUTSIDE)

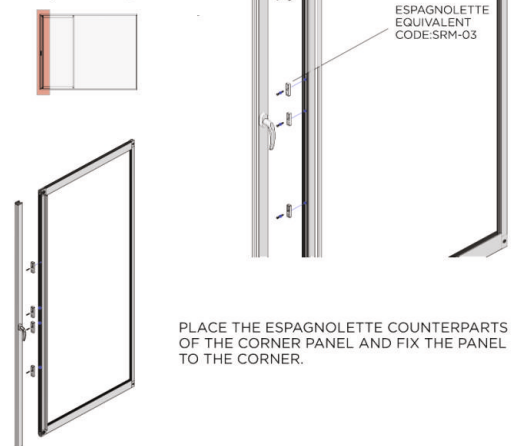

7

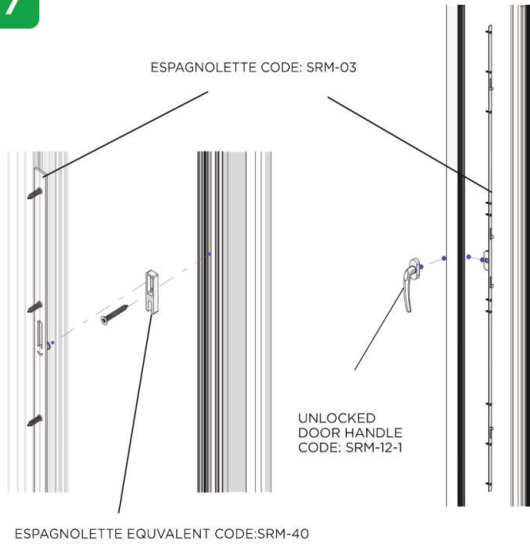

8



9

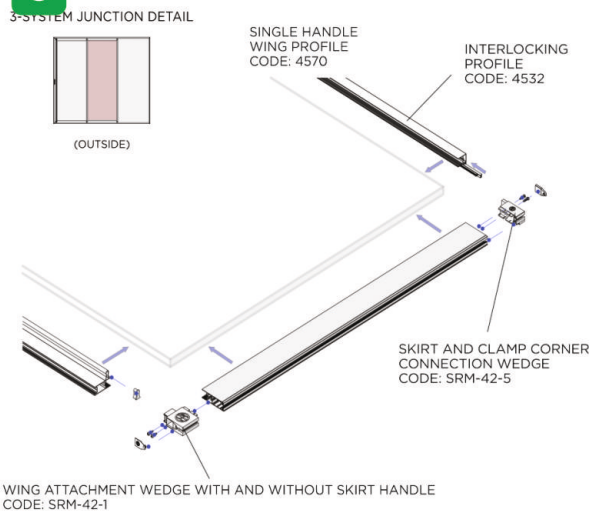

10

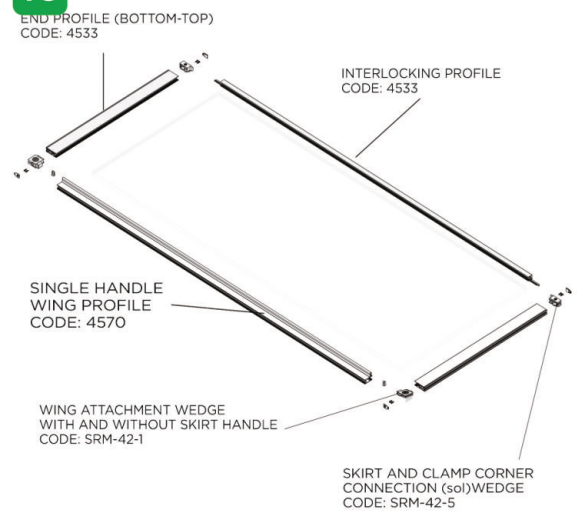

11

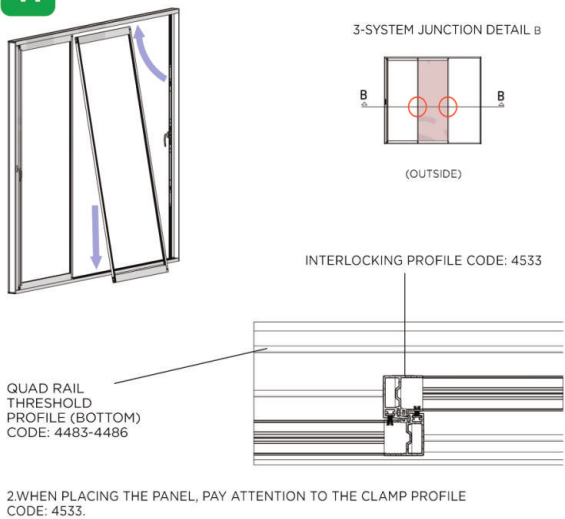

12

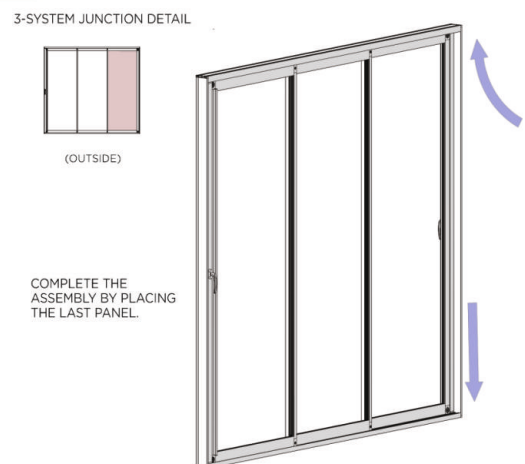



## 2 Top Rail Profile (Top)

Product Code	4483
Weight	1,092 kg/m

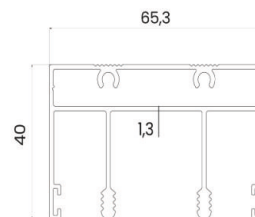

## 3 Top Rail Profile (Top)

Product Code	4484
Weight	1,460 kg/m

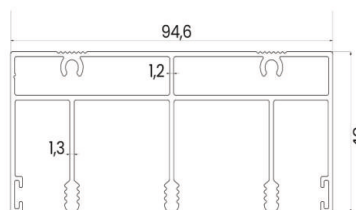

## 4 Top Rail Profile (Top)

Product Code	4485
Weight	1,901 kg/m

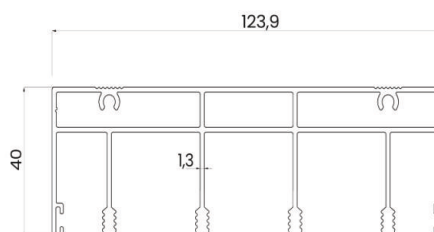

## 5 Top Rail Profile (Top)

Product Code	4486
Weight	2,254 kg/m

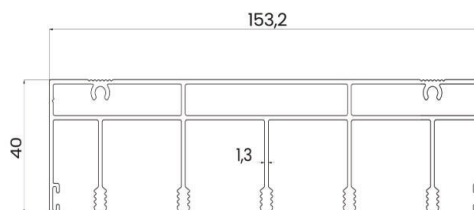

## 8 Ilık Tek Cam Adaptor Profili / Single 8 Glass Adapter Profile

Product Code	4499
Weight	0,201 kg/m

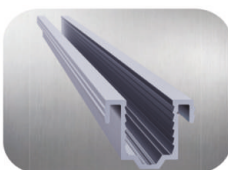
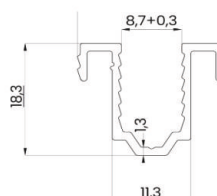

## 10 Ilık Tek Cam Adaptor Profili / Single 10 Glass Adapter Profile

Product Code	4500
Weight	1,193 kg/m

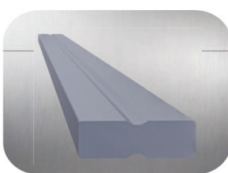
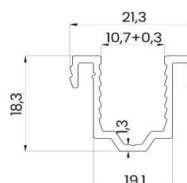

## Destek Profili / Support Profile

Product Code	4529
Weight	0,347 kg/m

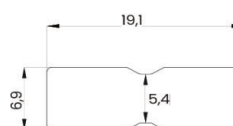

## Kanat Profili / Sash Profile

Product Code	4530
Weight	0,569 kg/m

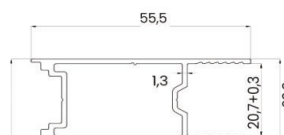

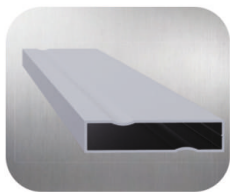

### Double Side Case Profile (Side)

Product Code	4495
Weight	0,529 kg/m

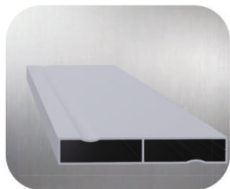
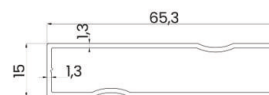

### 3 Yan Kasa Profili / Triple Side Case Profile (Side)

Product Code	4496
Weight	0,770 kg/m

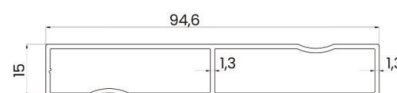

### Quad Side Case Profile (Side)

Product Code	4497
Weight	0,969 kg/m

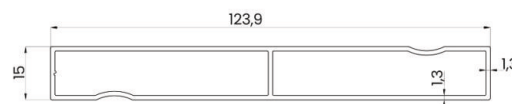

### Supported Clamp Profile

Product Code	4453
Weight	0,696 kg/m

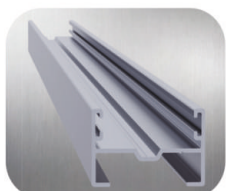
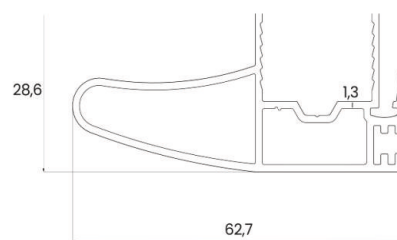

### Middle Joint H Profile

Product Code	4568
Weight	0,366 kg/m

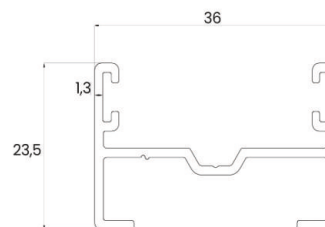

### Double Handle Wing Profile

Product Code	4569
Weight	0,946 kg/m

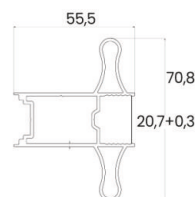

### Single Handle Wing Profile

Product Code	4570
Weight	0,759 kg/m

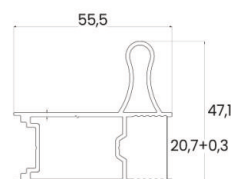

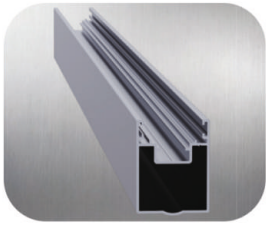

### Frame Adapter Profile(For Lock)

Product Code	4531
Weight	0,686 kg/m

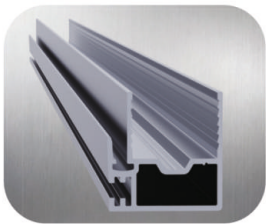
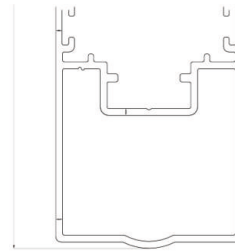

### Interlocking Profile

Product Code	4532
Weight	0,436 kg/m

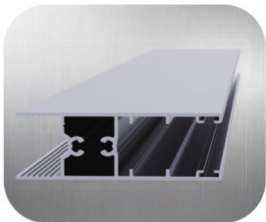
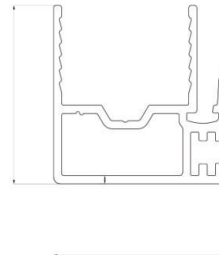

### End Profile(Bottom-Top)

Product Code	4533
Weight	0,816 kg/m

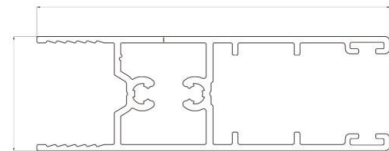

### 90 Corner Profile

Product Code	4534
Weight	0,651 kg/m

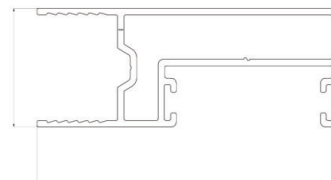

pcs Frame And Side Post Corner Connection Block



Code Piece **SRM-42-3**  
1 PCS

3-pack Frame And Side Post Corner Connection Block



Code Piece **SRM-43-1**  
1 PCS

4-pack Frame And Side Post Corner Connection Block



Code Piece **SRM-44-1**  
1 PCS

5-pack Frame And Side Post Corner Connection Block



Code Piece **SRM-45-1**  
1 PCS

90 Corner Connection Wedge (Left)



Code Piece **SRM-42-13**  
1 PCS

90 Corner Connection Wedge (Right)



Code Piece **SRM-42-14**  
1 PCS

Wing Connection Wedge with and without Skirt Handle(Left)



Code Piece **SRM-42-1**  
1 PCS

Skirt and Clamp Corner Connection Wedge (Right)



Code Piece **SRM-42-2**  
1 PCS

Skirt and Clamp Corner Connection Wedge(Left)



Code Piece **SRM-42-4**  
1 PCS

Skirt and Clamp Corner Connection Wedge (Right)



Code Piece **SRM-42-5**  
1 PCS

Lock Adapter Cover Plastic



Code Piece **SRM-42-6**  
1 PCS

Sliding Badge



Code Piece **SRM-42-7**  
1 PCS

Kulp Cover Plastic(Top)



Code Piece **SRM-49**  
1 PCS

Kulp Cover Plastic(Bottom)



Code Piece **SRM-50**  
1 PCS

Supported Clamp Profile Plastic



Code Piece **SRM-48**  
1 PCS

Stainless Sliding Wheel



Code Piece **SRM-23**  
1 PCS

Galvanized Sliding Wheel



Code Piece **SRM-23-1**  
1 PCS

Latch Lock



Code Piece **SRM-4**  
1 PCS

Pool Lock Zinc Alloy



Code Piece **SRM-51**  
1 PCS

Pool Lock Tongue and Groove (Sheet Metal)



Code Piece **SRM-34**  
1 PCS

Unlocked Door Handle



Code Piece **SRM-12-1**  
1 PCS

Locked Door Handle



Code Piece **SRM-13-1**  
1 PCS

Espagnolette



Code Piece **SRM-56**  
1 PCS

Frame And Side Post Corner Connection Block



Code Piece **SRM-40**  
1 PCS

Air Blocker



Code Piece **SRM-42-8**  
1 PCS

Double Top Connection Rail Bracket



Code Piece **SRM-42-9**  
1 PCS

4.8x5 Hair Fitting



Code Piece **SRM-15**  
1 PCS

6.7x5,5 Hair Fitting



Code Piece **SRM-14**  
1 PCS

YHB 3.9X13 Torque Head Screw



Code Piece **SRM-42-10**  
1 PCS



**SPS BIOCLIMATIC**

**ZIP SCREEN**

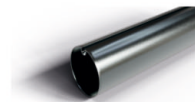
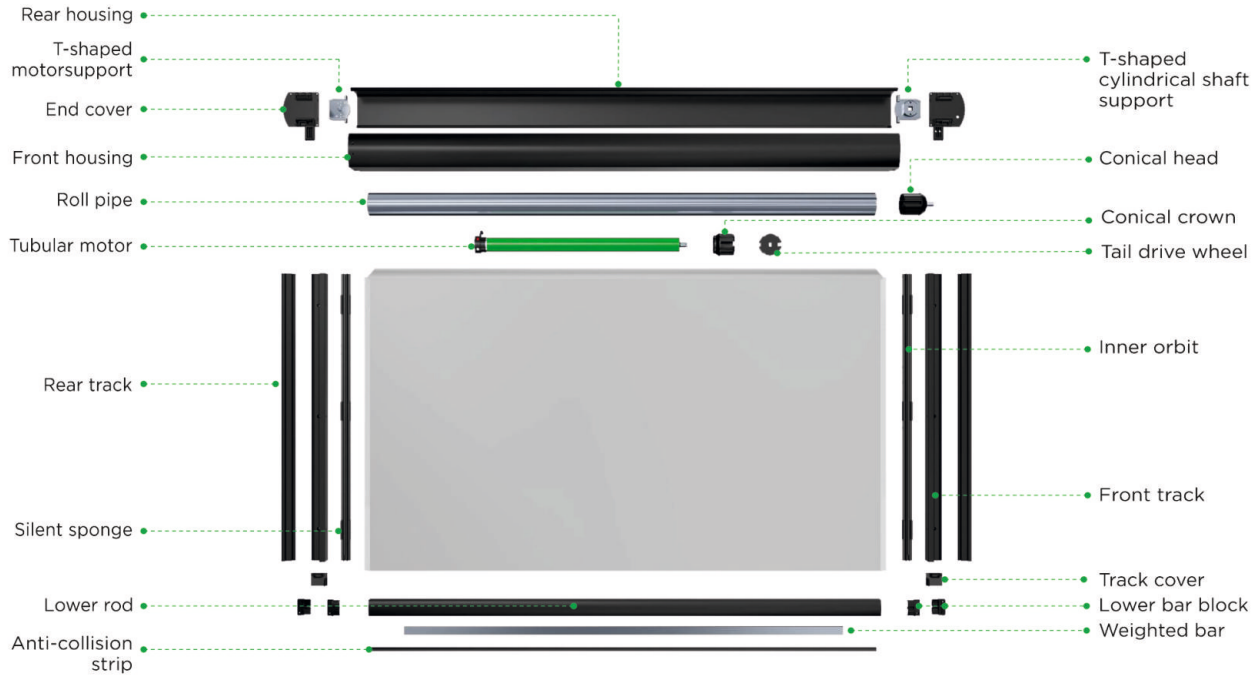

Galvanized reinforced iron pipe, can be adapted to 70/80 pipes.

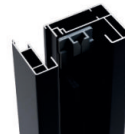
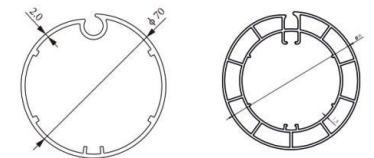

Double-layer split track, more firm, with a standard silent sponge.

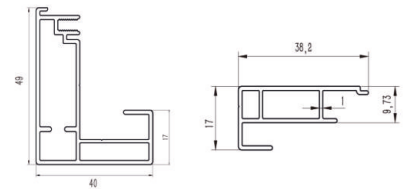

- Resist the wind**
- Sun protection**
- Rainproof and waterproof**
- Prevent mosquitoes**
- Protect privacy**
- Breathable and viewable**

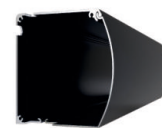

108mm aluminum alloy cover, high density powder spray.

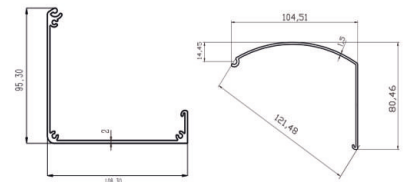

## BASIC PARAMETERS

Size	Max: Width 7 meters x Height 5.5 meters
Color	White/light gray/dark gray/brown and other colors can be customized
Control	Single frequency remote control/ Dual frequency remote control Multi-frequency remote control
Material	6063 aluminum alloy + stainless steel accessories
Surface	Pure resin outdoor metal high-density powder spray



The lower rod weight is more stable, standard with anticollision rubber strips.

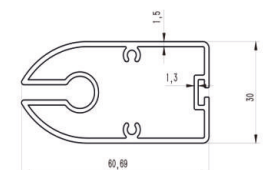

## FRONT MOUNTING

Outside the frame.

The track is mounted outside the frame and the track fixing screws are driven from the side of the track.

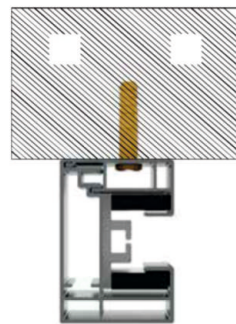

## SIDE MOUNTING

Inside the frame.

The track is installed in the frame and the track fixing screws are drawn from the underside of the track.

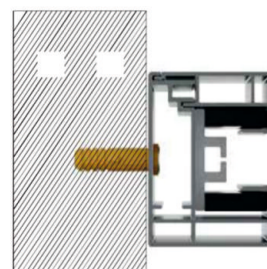

HK - Polyester Fiber Series		
Project	Implementation Standard	Parameter
Material		75%PVC+25%Polyester
Porosity	FZ/T01009-2008	0%
Gram Weight	GB/T4669-2008	630 g/m <sup>2</sup>
Thickness	FZ/T01003-1991	0.78 mm
UV shading rate		≈ 100%
Fire protection standard	GB17591-1996	National standard B1 level



HK-8001

HK-8002

HK-8003

HK-8004

HK-8005

HK - Polyester Fiber Series		
Project	Implementation Standard	Parameter
Material		25%Polyester+75%PVC
Porosity	FZ/T01009-2008	10%
Gram Weight	GB/T4669-2008	560 g/m <sup>2</sup>
Thickness	FZ/T01003-1991	0.7 mm
UV shading rate		≈ 70-90%
Fire protection standard	DIN4102	National standard B1 level

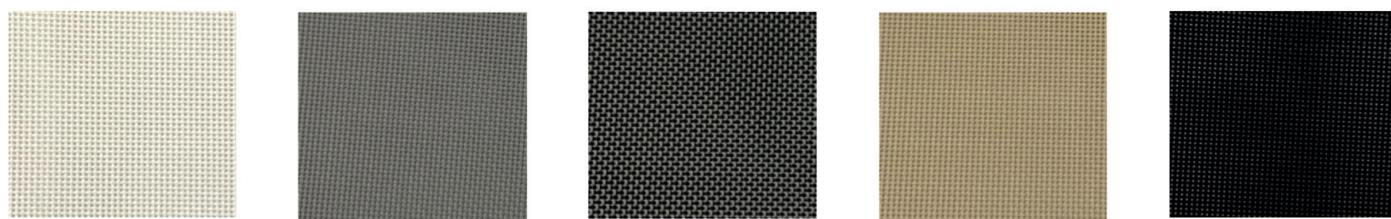

HD-3001

HD-3002

HD-3003

HD-3004

HD-3005

HB - Twill Glass Fiber Series		
Project	Implementation Standard	Parameter
Material		30%Glass Fiber+70%PVC
Porosity	FZ/T01009-2008	≈ 2%
Gram Weight	GB/T4669-2008	660 g/m <sup>2</sup>
Thickness	FZ/T01003-1991	1 mm
UV shading rate		≈ 98%
Fire protection standard	GB50222-1995	National standard B1 level

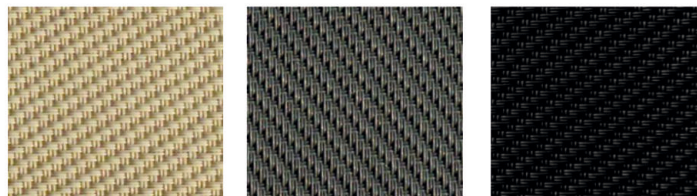

HB-200-1

HB-200-2

HB-200-3

HB - Twill Glass Fiber Series Project		
Project	Implementation Standard	Parameter
Material		30% Glass Fiber +70%PVC
Porosity	FZ/T01009-2008	≈ 5%
Gram Weight	GB/T4669-2008	600 g/m <sup>2</sup>
Thickness	FZ/T01003-1991	0.75 mm
UV shading rate		≈ 95%
Fire protection standard	GB50222-1995	National standard B1 level



HB-5001

HB-5002

HB-5003

HB-5004

HB-5005

HB-5006

HB-5007

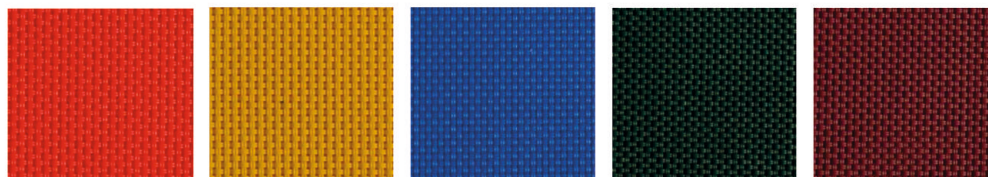

HC-6001

HC-6002

HC-6003

HC-6004

HC-6005



**SPS BIOCLIMATIC**

**WIND BREAKER**

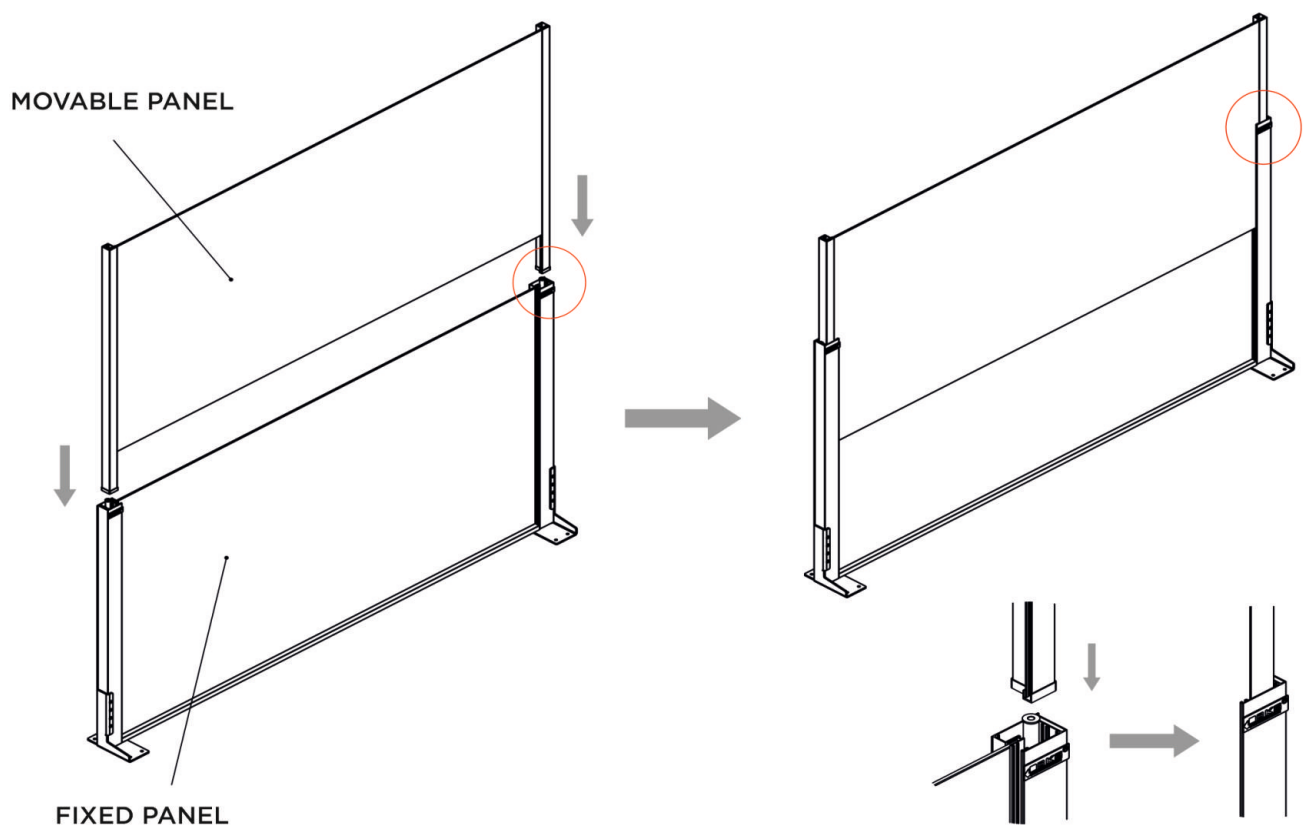

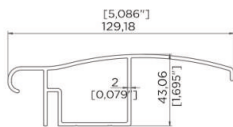
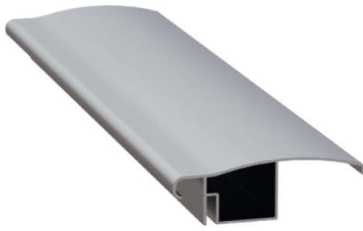

### HANDRAIL PROFILE

Product Code	3040
Weight	1,572 kg/m 3,466 lb/m

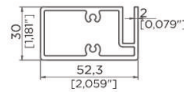

### GLASS PANEL BOTTOM PROFILE

Product Code	3042
Weight	1,210 kg/m 2,667 lb/m

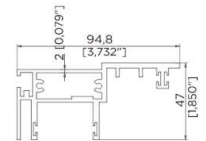

### FIXED PANEL PILLAR PROFILE

Product Code	3039
Weight	2,110 kg/m 4,652 lb/m

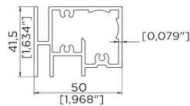
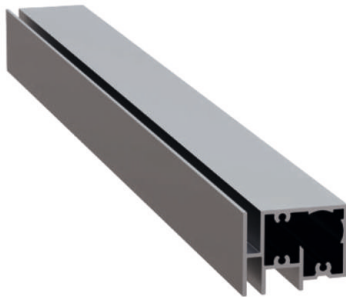

### PILLAR PROFILE WITH PISTON

Product Code	3043
Weight	1,390 kg/m 3,064 lb/m

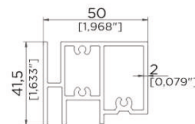
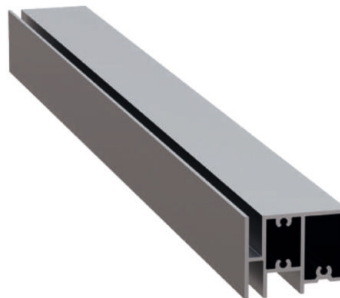

### MOVABLE GLASS SIDE PROFILE

Product Code	3041
Weight	1,450 kg/m 3,197 lb/m

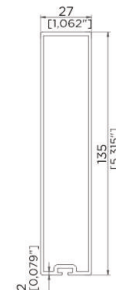
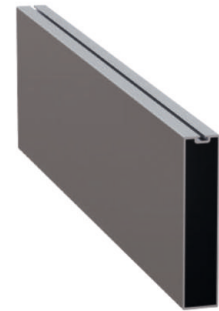

### WEIGHT PROFILE

Product Code	3492
Weight	1,415 kg/m 3,119 lb/m

**Wind breaker accessories set (with piston)**  
Code: RK-1



Ground connection Apparatus

Code Piece **RK-1 2**



Piston fixing apparatus

Code Piece **RK-1 2**



Connection fixing Apparatus

Code Piece **RK-1 2**

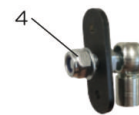

M6 nut

Code Piece **RK-1 2**



Fixed sewing plastic guide

Code Piece **RK-1 1 SET**



Movable system Locking device

Code Piece **RK-1 1**



Movable system safety lock

Code Piece **RK-1 2**



Fixed horizontal sewing cover

Code Piece **RK-1 4**



Wind breaker cover

Code Piece **RK-1 2**



3,9x16 mm shbs smart screw

Code Piece **RK-1 20**



3,9x25 mm shbs smart screw

Code Piece **RK-1 4**



3,9x38 mm shbs smart screw

Code Piece **RK-1 8**



3,9x32 mm shbs smart screw

Code Piece **RK-1 6**



3,9x50 mm shbs smart screw

Code Piece **RK-1 16**

**Wind breaker piston**  
Code: RK-3



Gas piston

Code Piece **RK-1 2**



Ground connection Apparatus

Code Piece **RK-3 2**



Fixed horizontal Sewing cover

Code Piece **RK-3 2 SET**



Wind breaker cover

Code Piece **RK-3 2**



Fixed sewing plastic guide

Code Piece **RK-3 4**

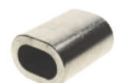

Wire lock

Code Piece **RK-3 4**

**Wind breaker accessories set (manuel)**  
Code: RK-2



Steel wire

Code Piece **RK-3 1 SET**



Fixed horizontal Sewing cover

Code Piece **RK-3 2 SET**



3,9x16 mm shbs smart screw

Code Piece **RK-3 20**



3,9x25 mm shbs smart screw

Code Piece **RK-3 4**



3,9x38 mm shbs smart screw

Code Piece **RK-3 8**



3,9x32 mm shbs smart screw

Code Piece **RK-1 6**



3,9x32 mm shbs smart screw

Code Piece **RK-1 6**



**SPS BIOCLIMATIC**

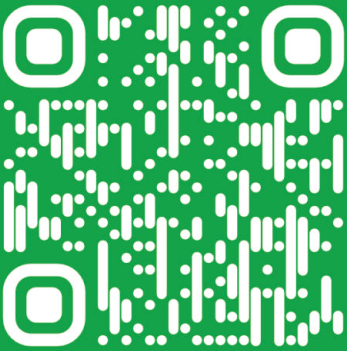

LINK WITH US:



[spsbioclimatic.com](https://spsbioclimatic.com)



[sps\\_bioclimatic](https://www.instagram.com/sps_bioclimatic)



[spsbioclimatic](https://www.tiktok.com/spsbioclimatic)

**DUBAI**

**TURKIYE**



**+971 58 575 83 98**



**+90 507 407 97 96**